

COITSVILLE TOWNSHIP

GENERAL MAP

N.W. QUARTER

GIS  
7-5-06

POLAND TWP.

TOWNSHIP 1  
RANGE 1

Removed from  
Map Book to  
file in 7-18-96.  
(lc)

OFFICE OF  
MAHONING COUNTY  
ENGINEER

TAX MAP DEPT.

76 INDICATES SECTION NUMBER  
37 INDICATES PLATE NUMBER

SCALE 1" = 800'

35

36

38

39

CITY OF YOUNGSTOWN

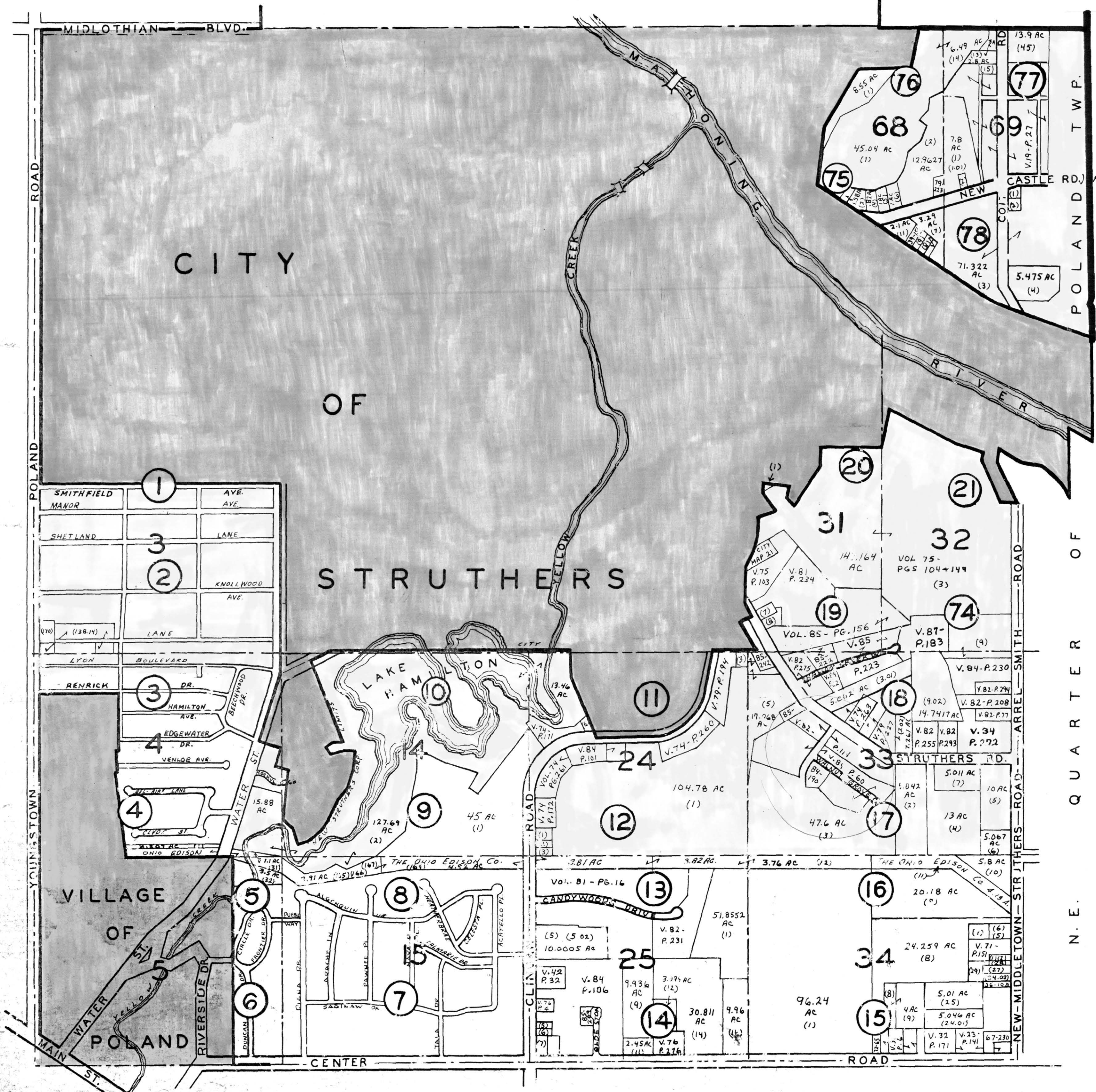

S.W. QUARTER