

SE PLATE 119
G.L. No. 23
N. SURVEY
MILTON TWP.
OFFICE OF COUNTY ENGINEER
MAHONING COUNTY COURT HOUSE
YOUNGSTOWN, OHIO

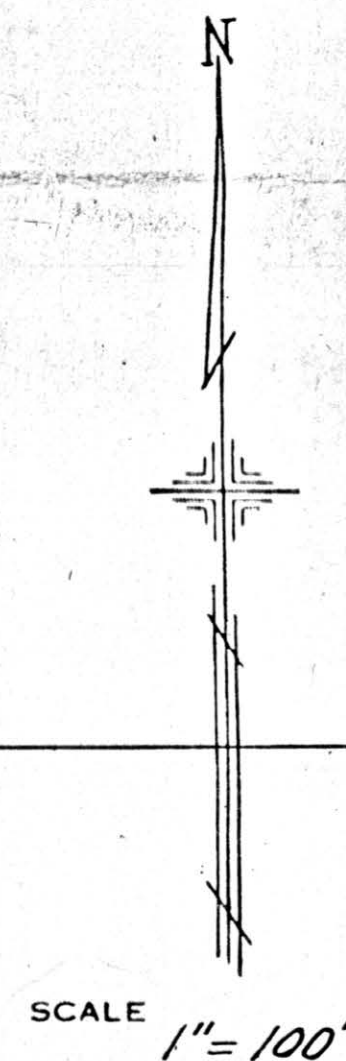

See
Map # 75
E.F. HLASTA
442/351
= John M. Jr. & V. Adams
= 91.71 A. (PA)
87.17 AC
83.13 AC

See
Map # 74
P. PROZY & J. PITTMAN
522/209
#R. Helsel
5.0A.

118

74

120

129

128

See
Map # 118
R.D. F.G. EDDINGER
E.J.R. FISHER
23.16 A. (S. PT.)
14.533 A. (PT.)
6.778 A. (S. PT.)
5.95 A. (PT.)

588.31'
549/471
#R. Helsel
5.87A.

559.54'
A. & A. Spiny
599/349
2A.

557
562.8
P.H. & E. PROZY
5.01Ac.

RE-PLAT
E. F. FISHER PLAT
VOL. 18 - PG. 203
Vol. 51 - Pg. 306

LAKE MILTON BAPTIST TEMPLE, INC.
9.435 A.

P.K. & K. Prozy
41.25A.
39.98 A.
34.97 A.
28.634 Ac.

8.01
PAUL H. & EVELYN E. PROZY
6.326 Ac.

RE PLAT
577/257
EL. S. EL. LONG
L. L. Mercer
9A.
2.063A.
3
S. 75

KAZMER PROZY PLAT NO. 1
VOL. 45 - PG. 240

RE PLAT
VOL. 45
VOL. 49

STOLTZ ROAD
7/7.42'