

625  
719-06

OFFICE OF COUNTY ENGINEER  
MAHONING COUNTY COURT HOUSE  
YOUNGSTOWN, OHIO

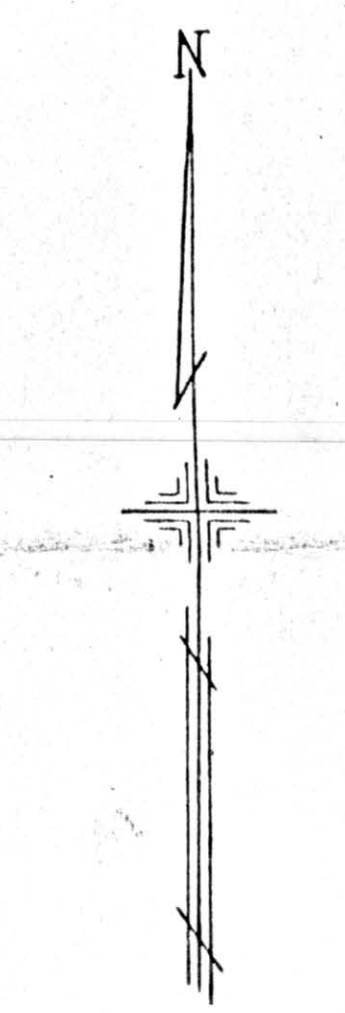

SCALE  
1" = 100'

86

LEGEND

(21) PLATE NUMBER

→ 4700 HOUSE NUMBERING GRID

[4170] HOUSE NUMBER

88

92

90

ROAD  
60'

BANDY ROAD  
SEC. 20  
SEC. 21

COURTNEY ROAD

Match

Match

LINE

NORMAN E. EVELYN J. SUMMERS  
#D.J. & P.L. HAUBERT  
#Rose Hannen  
#40 A. (Pt.)  
#16.536 A. (Pt.)  
15.326 A.

#D.J. & P.L. HAUBERT  
#Rose Hannen  
#26.33 A. (Pt.)  
8.495 A. (Pt.)

WM. & BERNICE MARSHALL  
#L.J. KRUG  
32.113 A. (Pt.)

J. & M. J. BRODZINSKI  
#H. Snade  
52.75 A. (Pt.)

R. GREENEISEN  
#R.L. & A. Sickle  
#6.093 A.  
6.A

226  
N. SUMMERS  
#1  
Vol. 69 - Pg. 193  
A.W. & F.M. Bartholomew  
#JOHN HAWKINS  
1.504 A.

H. SNODE  
PL. #1  
Vol. 64  
Pg. 81

#E.E. Eells  
#V.J. & M.L. HOPTON  
SHIRLEY M. WILSON  
#W.J. PHILLIPS  
1.909 A.

#W.J. Phillips  
#75.101 A. (Pt.)  
71.306 A.  
GREEN VALLEY FARMS, INC.

W.M. & N.A. WISELEY  
D. 5.3 A.  
L.L. & D.M. BROOK  
#R.G. & A.D. BOSTWICK  
#H.A. & S. HOPKES  
#C.A. & M.L. BOSTWICK  
#J.A. & O. FITZMAN  
#C.W. & F.G. LUOT

R.J. PHILLIPS  
#C. & D. HILKER  
#J.A. & O. FITZMAN  
#C.W. & F.G. LUOT

#B.F. & Leo Midland  
809 A.

PAUL R. FORSHEY  
PLAT No. 1  
#E. & L. ...  
3.273 Ac.  
VOL. 70  
PL. 174

J. R. & M. Hendershott  
#73/585  
39.975 A. (Pt.)

25 A. (Pt.)

Sec. map  
#90

