

MAHONING COUNTY
OHIO
BOARDMAN TOWNSHIP
Great Lot 26, Division 3 Great Lot 23 Division

TAX MAP
29007

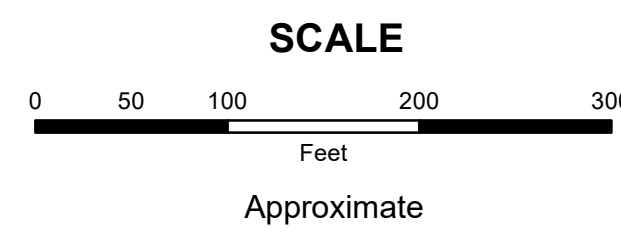

Print Date 12/31/2019

- LEGEND**
- COUNTY LINE
 - TOWNSHIP LINE
 - CITY LINE
 - VILLAGE LINE
 - PLAT OUTLINE
 - PARCEL LINE
 - OLD PARCEL LINE
 - PHASE LINE
 - ROAD ROW LINE
 - RAILROAD ROW LINE
 - (01-20-1.03) PARCEL ID NUMBER
 - 345 LOT NUMBER
 - BELL PLAT 1 PLAT NAME
 - 01004 TAX MAP NUMBER

BOARDMAN TOWNSHIP
Index Map

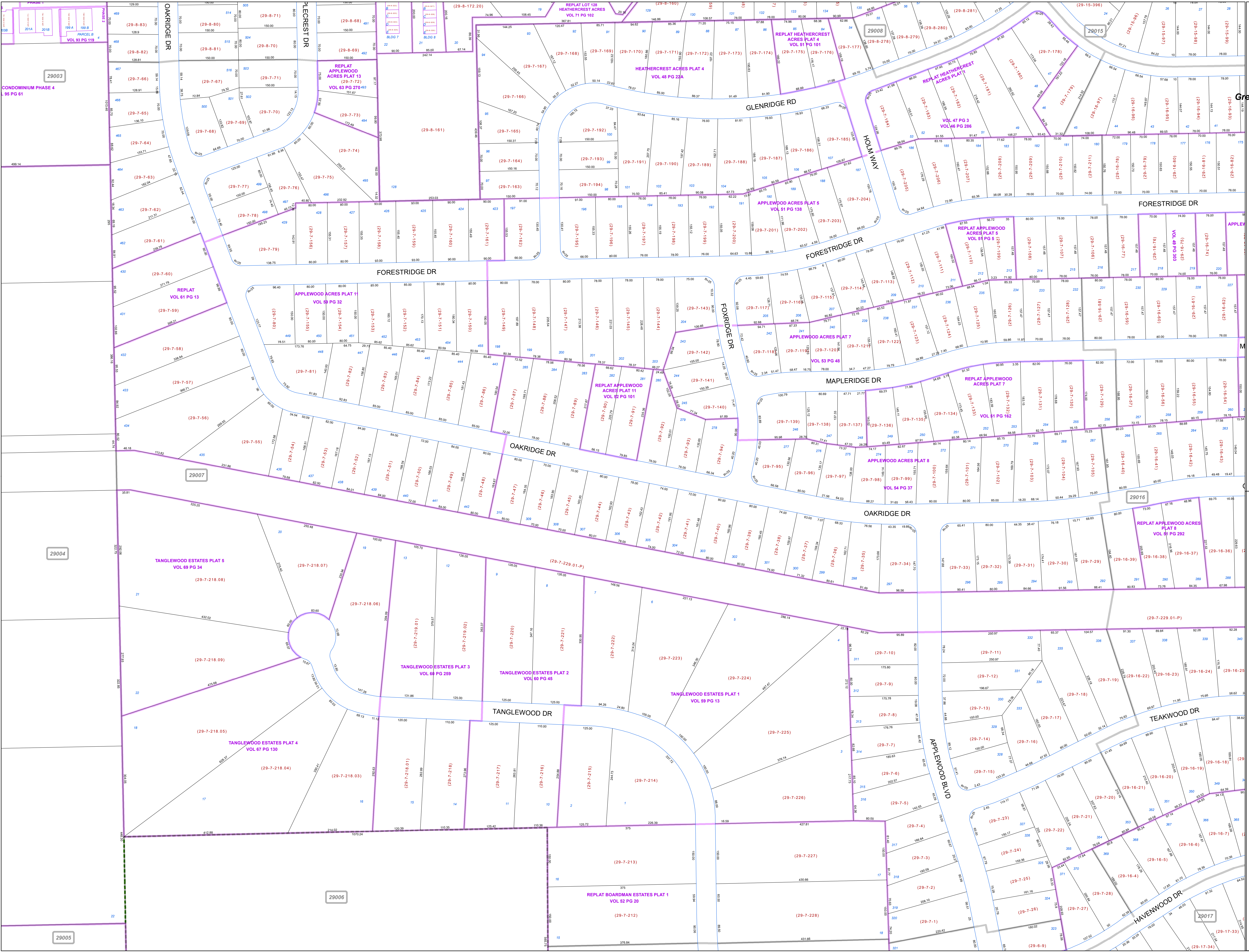
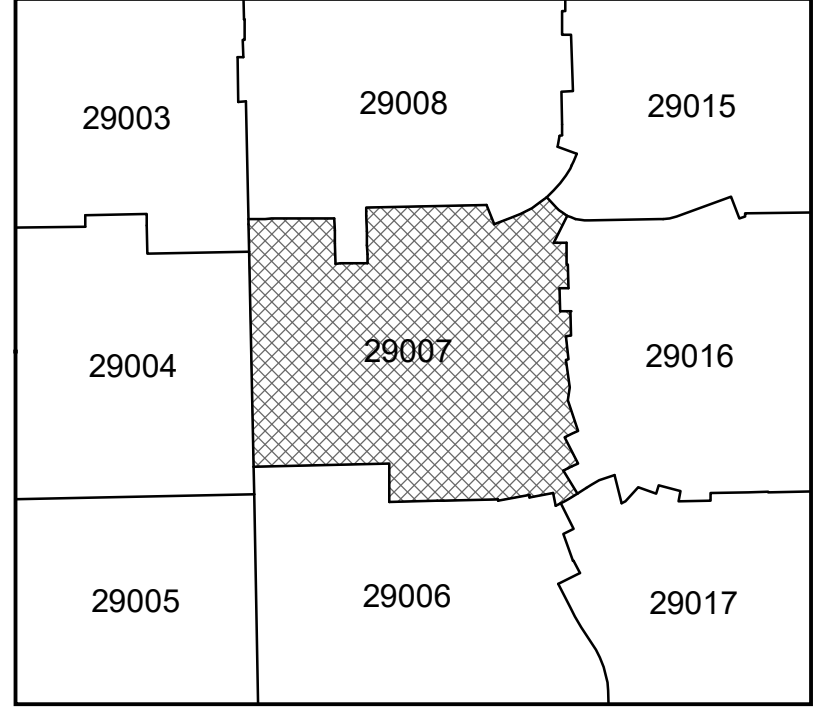

29003

29007

29004

29016

29006

29005

29017