

MAHONING COUNTY
OHIO
BOARDMAN TOWNSHIP
Great Lot 26, Division 3 Great Lot 23 Division 4

TAX MAP
29007

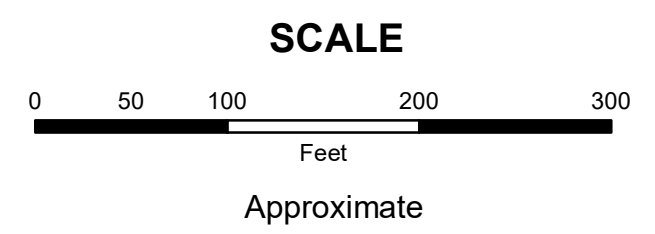

Print Date 12/29/2017

LEGEND

- COUNTY LINE
- TOWNSHIP LINE
- CITY LINE
- VILLAGE LINE
- PLAT OUTLINE
- PARCEL LINE
- OLD PARCEL LINE
- PHASE LINE
- ROAD ROW LINE
- RAILROAD ROW LINE
- (01-20-1.03) PARCEL ID NUMBER
- 345 LOT NUMBER
- BELL PLAT 1 PLAT NAME
- 01004 TAX MAP NUMBER

BOARDMAN TOWNSHIP
Index Map

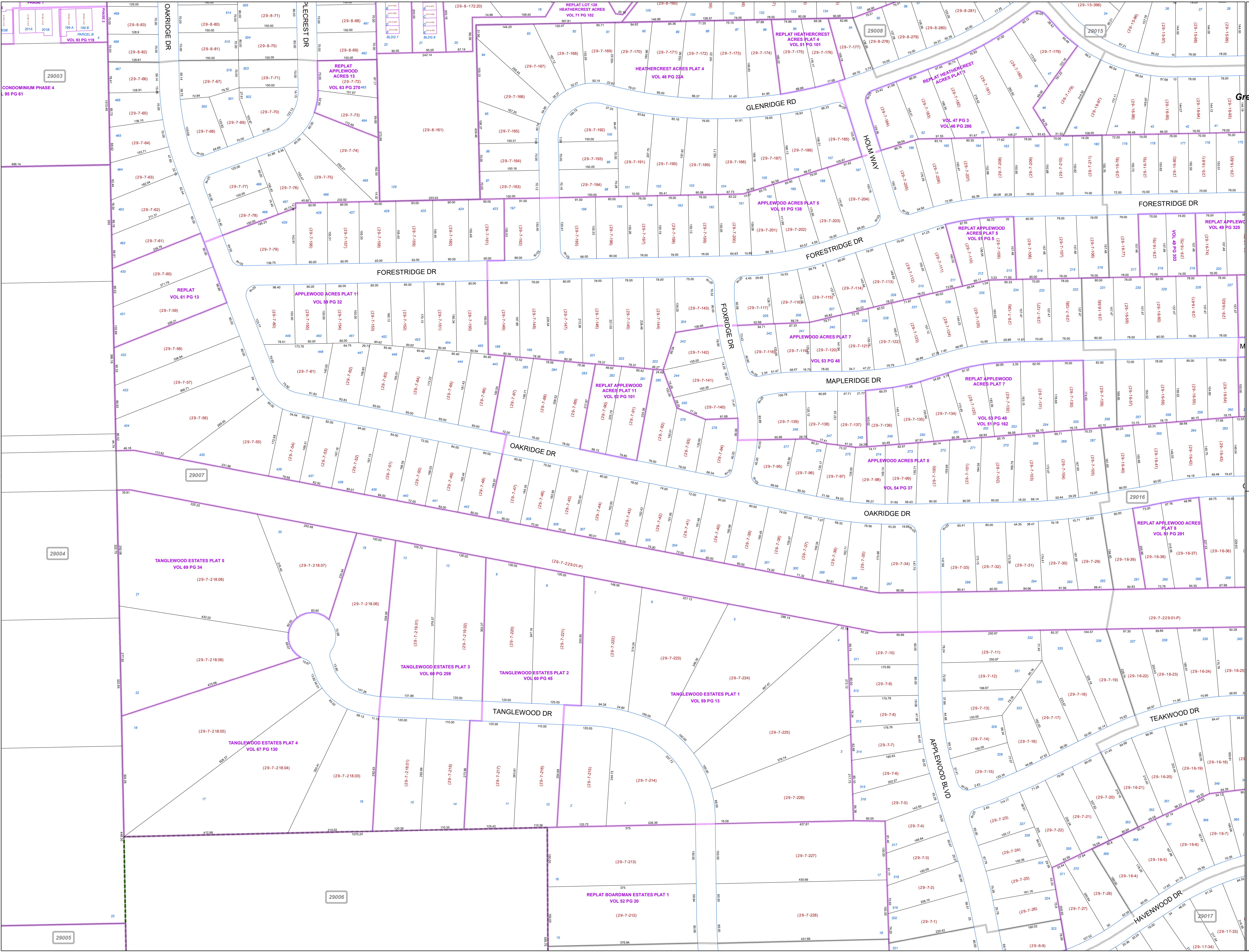
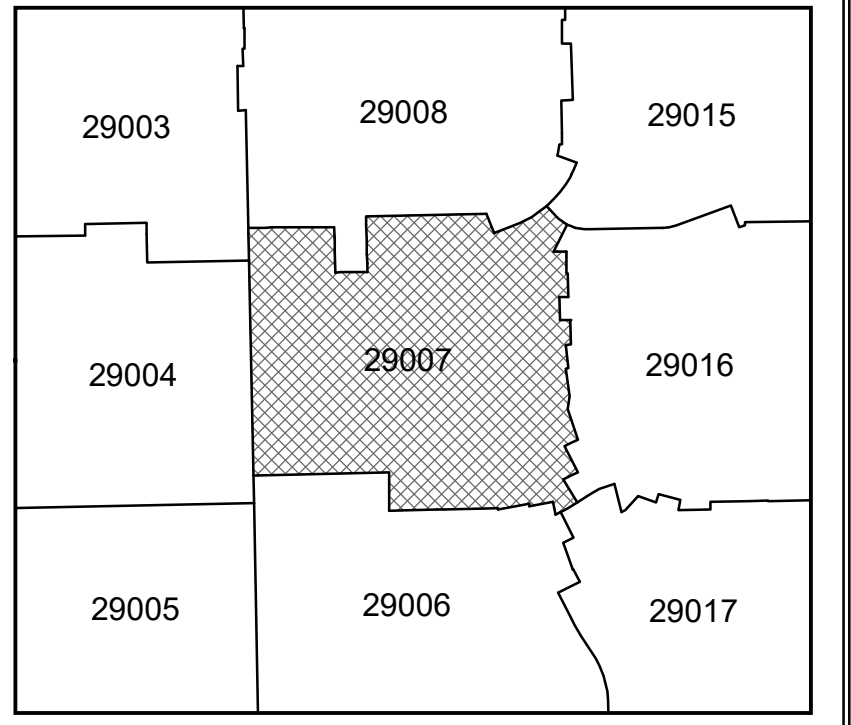

29003

29007

29004

29016

29006

29005

29017