

**MAHONING COUNTY  
OHIO  
POLAND TOWNSHIP**

**TAX MAP  
35023**

SCALE  
1 inch = 120 feet  
Approximate



0 50 100 200 300 Feet

Print Date Dec 31, 2011

**LEGEND**

- COUNTY LINE
- TOWNSHIP LINE
- CITY LINE
- VILLAGE LINE
- PLAT OUTLINE
- PARCEL LINE
- OLD PARCEL LINE
- PHASE LINE
- ROAD ROW LINE
- RAILROAD ROW LINE
- (01-20-1.03) PARCEL ID NUMBER
- 345 LOT NUMBER
- BELL PLAT 1 PLAT NAME
- 01004 TAX MAP NUMBER

**POLAND TOWNSHIP  
Index Map**

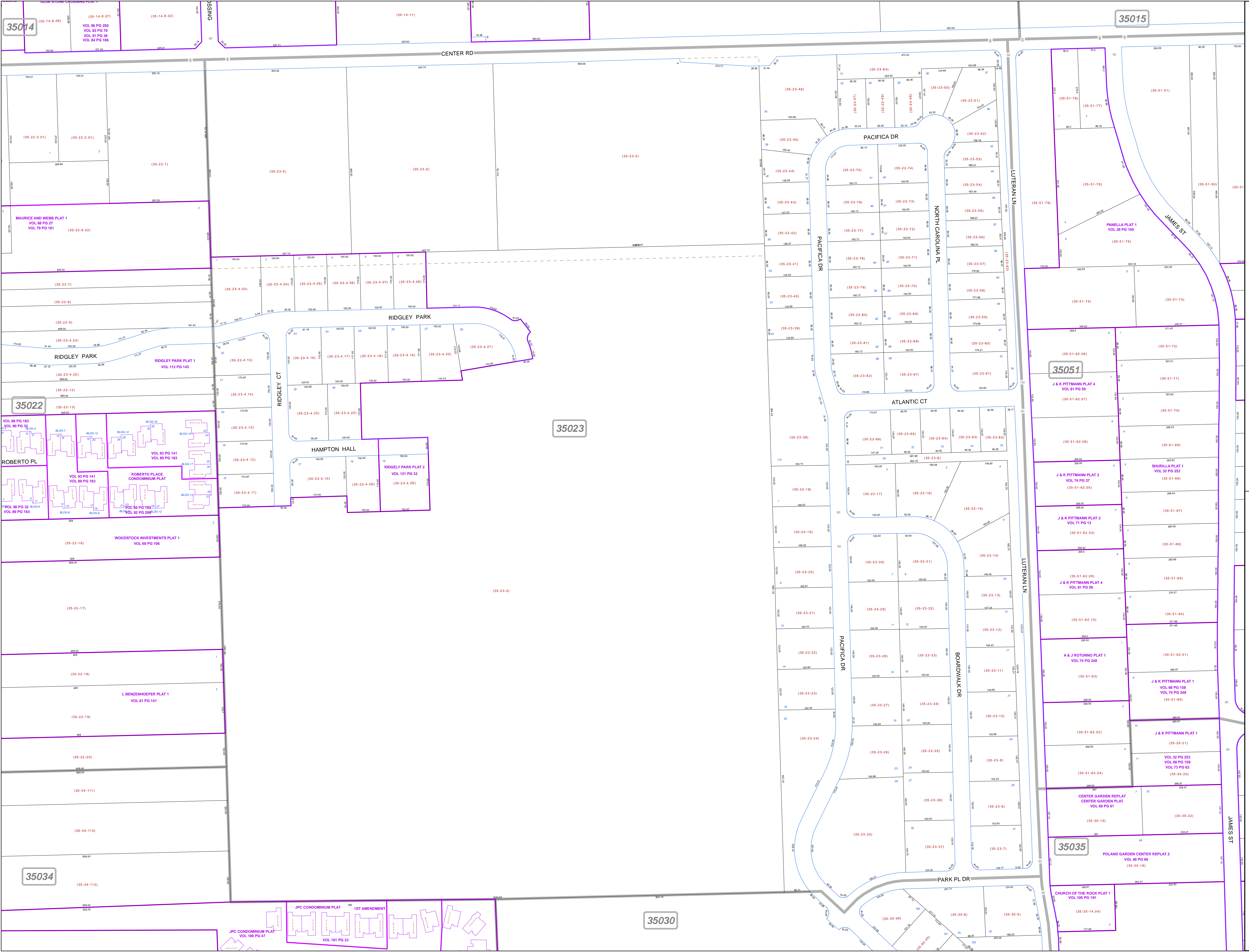
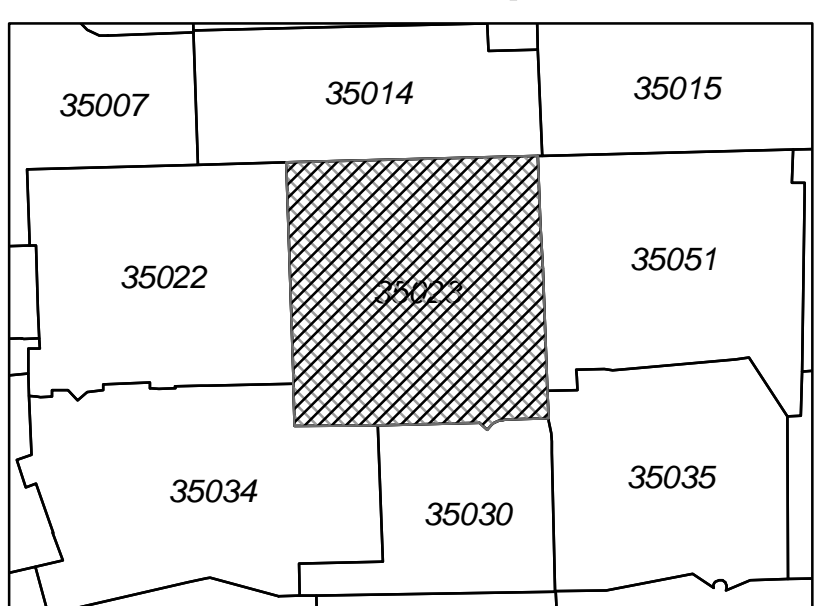

35014

35015

35023

35051

35022

35034

35030

35035