

MAHONING COUNTY
OHIO
SMITH TOWNSHIP
 Section 30

TAX MAP
19028

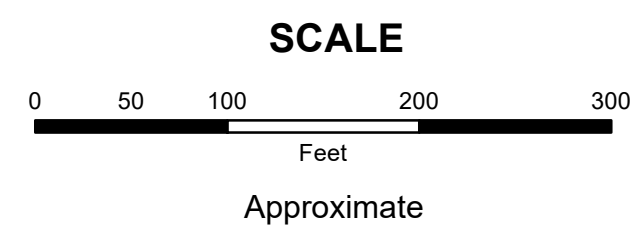

Print Date 1/14/2019

LEGEND

- COUNTY LINE
- TOWNSHIP LINE
- CITY LINE
- VILLAGE LINE
- PLAT OUTLINE
- PARCEL LINE
- OLD PARCEL LINE
- PHASE LINE
- ROAD ROW LINE
- RAILROAD ROW LINE
- (01-20-1.03) PARCEL ID NUMBER
- 345 LOT NUMBER
- BELL PLAT 1 PLAT NAME
- 01004 TAX MAP NUMBER

SMITH TOWNSHIP
Index Map

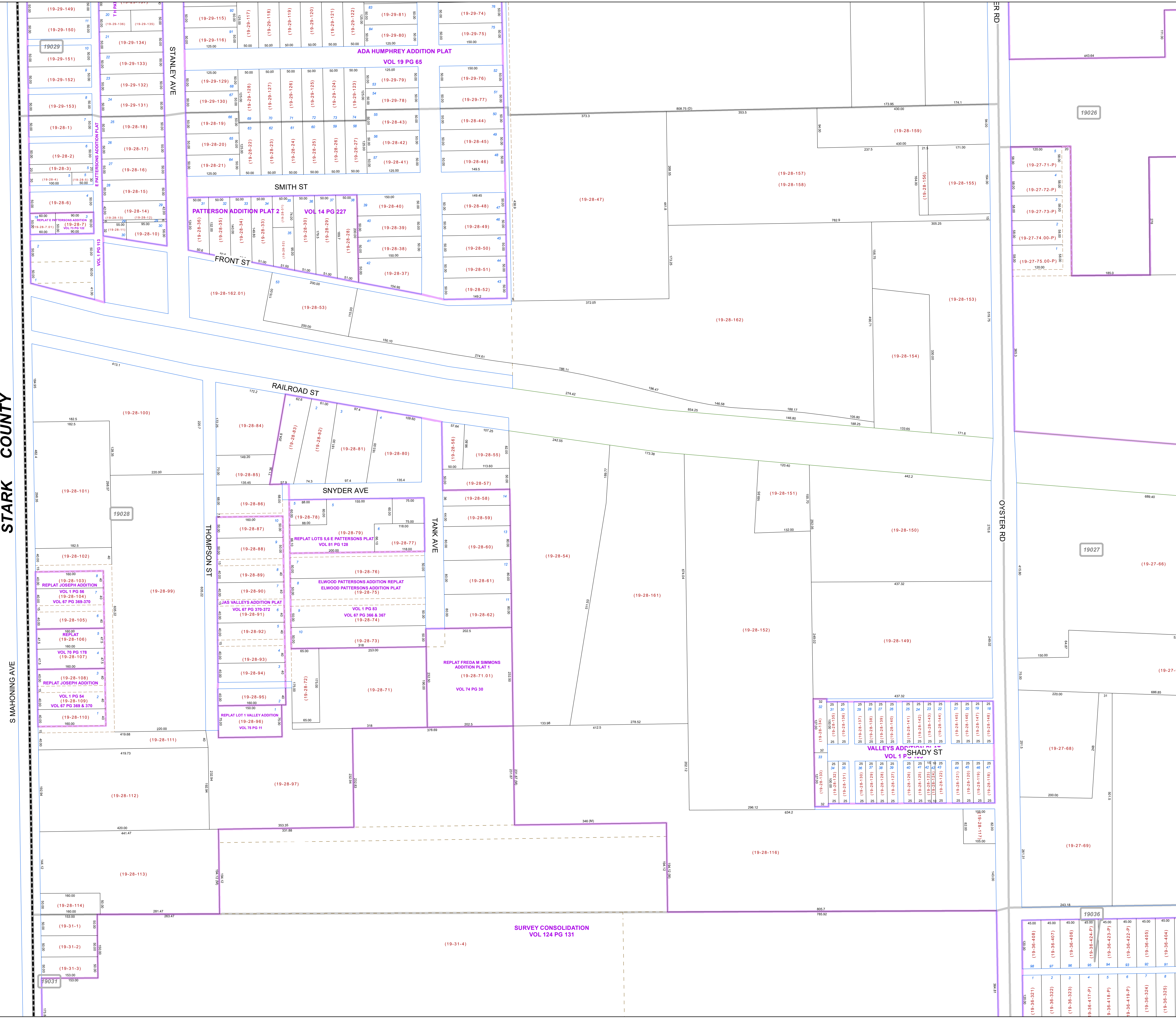
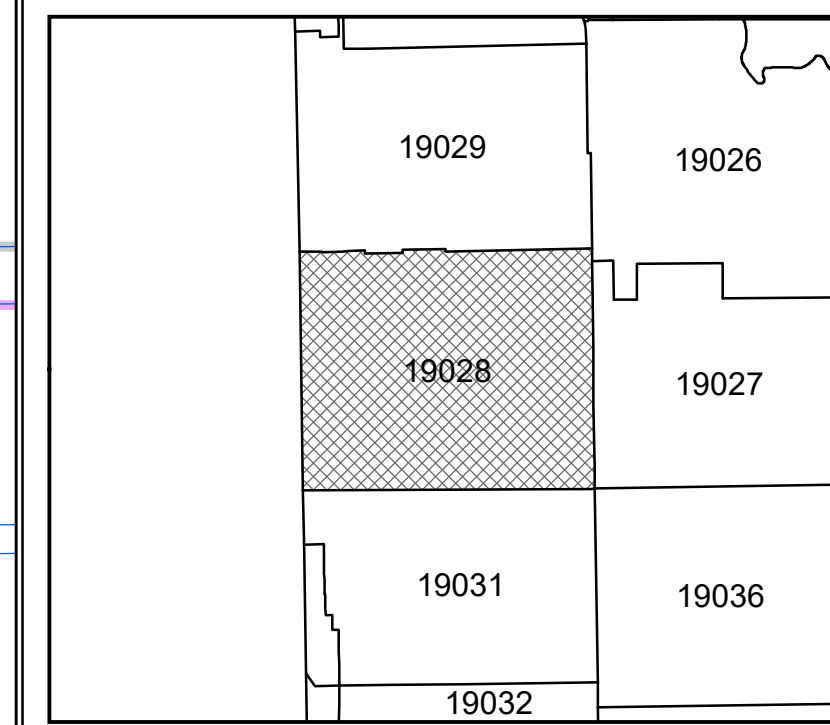

STARK COUNTY

S MAHONING AVE

19031

19032

19031

19028

19027

19026

19029

19028

19027

19026

19027

19028

19026

19027

19028

19026

19027

19028

19026

19027

19028

19026

19027

19028