

Range 2

BOARDMAN

Town 1.

Scale 2 inches to the Mile

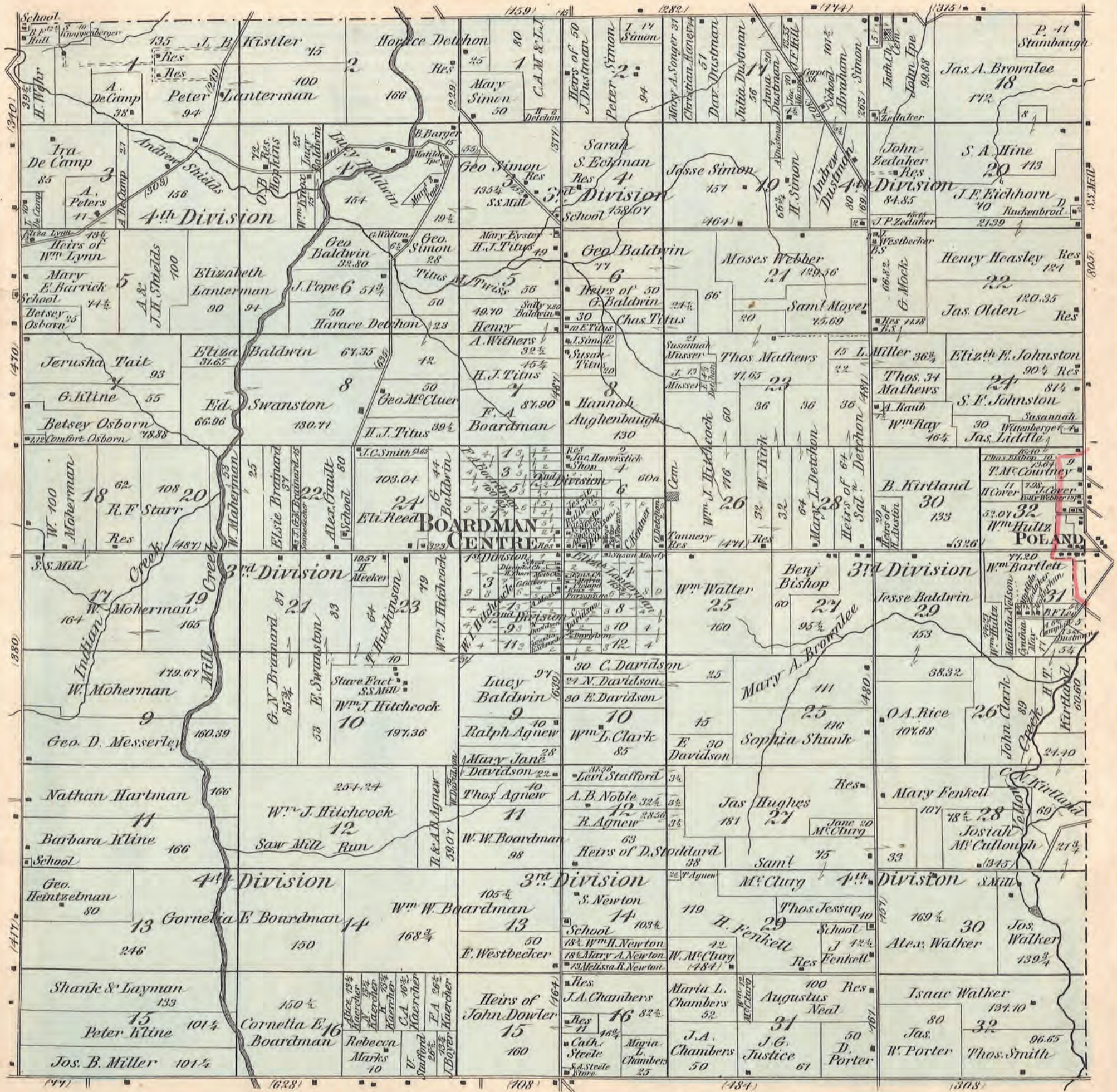

Boardman Towns'p Business Directory.

Oswald Detchon, Stock Dealer and Propr. of Tannery. All kinds of dressed Leather kept constantly on hand. Highest price paid for Hides, Pelts, and Bark.

Wm. Kirk, Farmer and Dealer in Horses, Cattle, Sheep, and Stock generally, 1 mile east of Boardman Centre.

John M. Osborn, Farmer, and Dealer in Horses, Cattle, Sheep, Hogs, &c.; also, fancy stock Poultry, &c., 2½ miles north of Boardman Centre.

Sheldon Newton, Representative from the 17th District. Boardman Centre.

George Simon, Proprietor of Steam Sawmill and Manufacturer of Shingles, Staves, Barrels, Heading, Cider, &c., 1½ mile north of Centre.

J. H. Shields, Stock Dealer, buys and ships Horses, Cattle, Sheep, &c., and Stock generally, Lot 18.

G. E. Lanterman, Farmer and Dealer in Horses, Cattle, Sheep, and Stock generally, Centre.

Jacob Haverstick, Manufacturer of Pumps of all kinds. Repairing promptly attended to. Boardman Centre.