

RECORD OF ROADS IN MAHONING COUNTY OHIO

INDEX TO ESTABLISHMENTS & VACATIONS

OFFICE OF COUNTY ENGINEER

SAMUEL GOULD, JR.
COUNTY ENGINEER
1944

REVISED - DEC. 1934. - DEC. 1935 - JUNE 1938 - JUNE 1941 - APRIL 1943 - JAN 1948

HISTORY

Mahoning County was established February 16th 1846. The north two tiers of township are in the Connecticut Western Reserve and were formerly part of Trumbull County. The south tier of townships is in the original "Seven Ranges" and was formerly part of Columbiana County. In the Western Reserve the townships are approximately five miles square, and in the "Seven Ranges" the townships are approximately six miles square.

All Road Records previous to February 16, 1846 are transcribed from the records of the Counties in which the road was located at the time of the road establishment.

Width of Roads - Some records do not designate widths of Right of Way. In such cases the State Law in effect at time of establishment determines the width. For Brief and citations of laws in reference to width of roads and method of determining the same when width is not designated or the record is lost see Road Record Vol. 4 Page 141

A summary of required widths as shown by these Laws is as follows:-

ROADS ESTABLISHED BY STATE LEGISLATURE

From 1824 to 1831 all state roads are 66 ft wide.
From 1831 to the present time 60 ft wide.

COUNTY ROADS

From 1792 to 1804 any width necessary
From 1804 to 1806 any width necessary not over 66 feet.
From 1806 to 1809 any width necessary not over 60 feet.
From 1809 to 1816 any width necessary not over 66 feet.
From 1816 to 1820 any width necessary not over 60 feet.
From 1820 to 1824 any width between 30 feet and 60 feet with specified width to be set forth in the Commissioners Order.
From 1824 to 1844 all County Roads shall be 60 ft wide.
From 1844 to 1853 any width between 40 ft and 60 ft. the width to be recorded when established. The act of 1844 also permits any road previously established to be reduced to a width not less than 40 ft. upon petition to the Commissioners.
From 1853 to 1915 any width between 30 ft and 60 ft. to be determined by viewers.
From 1915 to the present time any width over 30 feet.

R9-T4	R8-T4	R7-T4	R6-T4	R5-T4	R4-T4	R3-T4	R2-T4	R1-T4
				NEWTON FALLS TRUMBULL CO.				
R9-T3	R8-T3	R7-T3	R6-T3	R5-T3	R4-T3	R3-T3	R2-T3	R1-T3
PORTAGE CO.				*YOUNGSTOWN OHIO				
R9-T2	R8-T2	R7-T2	R6-T2	R5-T2	R4-T2	R3-T2	R2-T2	R1-T2
R9-T1	R8-T1	R7-T1	R6-T1	R5-T1	R4-T1	R3-T1	R2-T1	R1-T1
ATWATER OHIO				*CANTON OHIO				
R8-T12	R7-T12	R6-T12	R5-T12	R4-T12	R3-T12	R2-T12	R1-T12	
ALLIANCE OHIO				*COLUMBIANA OHIO				
R8-T11	R7-T11	R6-T11	R5-T11	R4-T11	R3-T11	R2-T11	R1-T11	
STARK CO.				COLUMBIANA CO.				
R8-T10	R7-T10	R6-T10	R5-T10	R4-T10	R3-T10	R2-T10	R1-T10	
*CANTON OHIO				LIBBON OHIO				
R8-T9	R7-T9	R6-T9	R5-T9	R4-T9	R3-T9	R2-T9	R1-T9	
CARROLL CO.				EAST LIVERPOOL OHIO				
R7-T16	R6-T16	R5-T16	R4-T16	R3-T16	R2-T16	R1-T16		

ORIGINAL TOWNSHIPS AND RANGES

INDEX

MILTON ⑪	JACKSON ⑩	AUSTINTOWN ①	YOUNGSTOWN ⑮	COITSVILLE ⑥
BERLIN ③	ELLSWORTH ⑦	CANFIELD ⑤	BOARDMAN ④	POLAND ⑫
SMITH ⑬	GOSHEN ⑧	GREEN ⑨	BEAVER ②	SPRINGFIELD ⑭

The figure in the circle indicates the Page on which that particular Township will be found.

Drawn By Albert Coope.

1

AUSTINTOWN TOWNSHIP ROAD RECORD
INDEX TO ESTABLISHMENTS & VACATIONS

- ⑥ Number on Road indicates Index Number
- 50 Number over Road indicates Width of R. of W.
- Vacated Road

RANGE 3-TOWNSHIP 2



1

AUSTINTOWN TOWNSHIP ROAD RECORD
INDEX TO ESTABLISHMENTS & VACATIONS

INDEX NO	NAME OF ROAD	COUNTY ROAD NO.	SURVEYOR FILE NO.	ESTABLISHED		ALTERED		ALTERED		REMARKS
				RD. BK. VOL. PG.	DATE WIDTH	RD. BK. VOL. PG.	DATE WIDTH	RD. BK. VOL. PG.	DATE WIDTH	
1	Canfield-Niles	328	71	TRB 12	1803 66	TRB 106	1825 66			Var. J.R. 46
2	Kirk	146		TRB 16	1803 50					
3	Akron-Youngstown	ICH 18	207	TRB 37	1807	4 169	1929 Vac.	4 162A	1932 Var.	SR 18 - RETURNED TO COUNTY JOURNAL OF THE DIRECTOR OF HIGHWAYS
4	Meridian			TRB 43	1810 66			4 326A	1934 66	New Buff. Rib. Cor.
6	Raccoon-Four Mile Run	109	185	TRB 14	1803 66	TRB 77	1820 60	4 164	1929 P. 58	
7	Four Mile Run	119		TRB 26	1807 50	TRB 40	1809 66	4		347
8	Burky	164		TRB 72	1811					
9	CANFIELD RD.	S.H. 81		TRB 47	1811 60					
10	Turner	103	210	TRB 32	1807 50	TRB 71	1818 50	4 317	1933 50	
12	Turner	103		TRB 32	1807 50	TRB 71	1818 50			
13	Ohltown Rd.	105		TRB 106	1825 66					
14	Lanterman-Webb	184-192		TRA 230	1818 50					
15	Fairview	166		TRB 322	1838 60	4 181	1929 Vac.	4 397		
15	Wilcox	123	208	TRB 322	1838 60	4 253	1929 Vac.	4 277	1929 Vac.	UBER
*16	SILICA	178	44	TRB 177	1830 60	2 158	1888 60	CSR 408	1888	
17	Fairview	166	206	TRB 338	1840	4 181	1929 Vac.			
19	Vandivort	93		TRA 232	1841 60	4 265	1929 Vac.			
20	Mah-Trumbull Co. Line	4		TRA 270	1850 40					
*21	New	162	183	1 8	1847 40	4 157	1932 40	4 253	1929 Vac.	4-563-1946
22	Mah-Trumbull Co. Line	4		1 130	1862 40					
*23	Kirk	146	202	TRB 156	1829 60	1 102	1860 30	CSR 448	1904	
24	Riblet	198	135	3 73	1911 50					
25	Crum	182	90-91	2 231	1899 60	2 234	1900 50	CSR 423	1900 50	
26	Dunlap	180	165			4A 65	1925 40			
27	Vial	266	197	4A 121	1926 50					
28	Westminster Ave.	259		3 85	1923 50					
29	North Main St.	260		3 85	1923 50					
30	Carnegie Ave.	261		3 85	1923 50					
31	Public Square	265		3 133	1923 60					
32	Parkgate Ave.	262		3 133	1923 50					
33	South Main Street	263		3 133	1923 50					
34	Rosemont Ave.	264		3 133	1923 50					
35	Ohltown Viaduct	4-B	201	4 217	1929 60					
36	Turner	103	205			4 289	1929 Vac.			
37	Norquest Blvd.	284								Var.
38	MEANDER DRIVE	276								Established by Deeds TOWNSHIP ROAD.
39	LIBERTY LANE	275								Township Road.
40	LANTERMAN RD.	184	224	4 412	1939 50	4 486	1943 50			PLATTED
41	BURGETT	279		4 461	1943 60					PLATTED
42	Lake Drive	282								
43	Oakwood Ave	283		4 563	1946 70					SEE COMM. JR. VOL. 37 Pgs 344
44	South Meander Dr.	285	236	4 533	1946 50					
45	Benton	287								
46	Hendricks	286		27 92-93	1/40 50					
47	Howards	288								
*6	Four Mile Run	119				4 347				Var.
*16	SILICA	178	44			4 241	1929 Vac.			
*23	Kirk	146	202			4 205	1929 Vac.	4 325	1934 60	
48	KLEBER		262	5 411	1954 Vac.					
49	VICTORA	293		47 5	1959 60					
*21	NEW RD.	162		4 563	1946					

BEAVER TOWNSHIP ROAD RECORDS
INDEX TO ESTABLISHMENTS & VACATIONS

① Number on Road indicates Index Number
50 Number over Road indicates Width of R. of W. ----- Vacated Road
RANGE 2 - TOWNSHIP 13

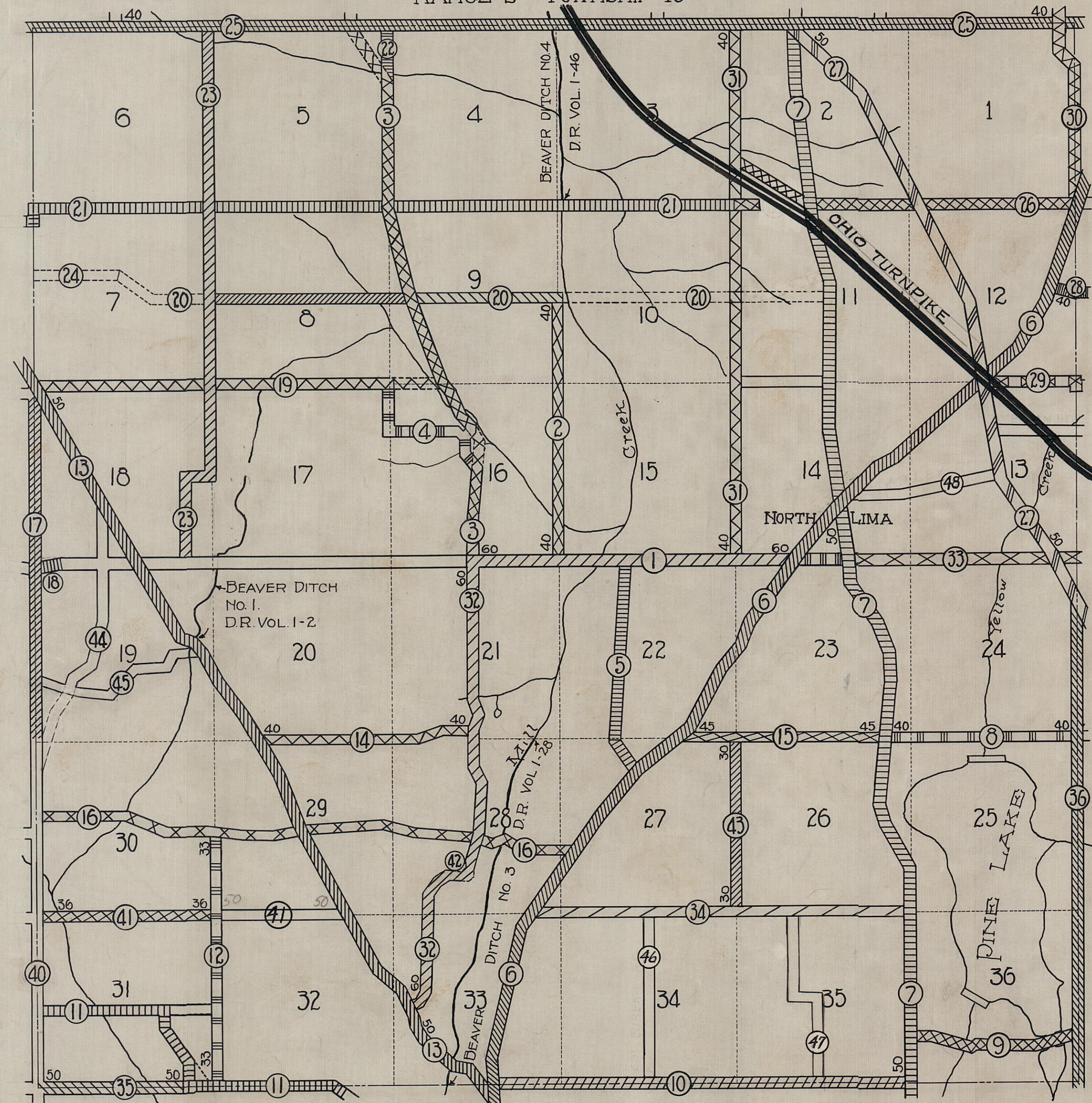

BEAVER TOWNSHIP ROAD RECORDS
INDEX TO ESTABLISHMENTS & VACATIONS

INDEX NO	NAME OF ROAD	COUNTY ROAD NO.	SURVEYOR FILE NO.	ESTABLISHED		ALTERED		ALTERED		REMARKS
				RD. BK. VOL. PG.	DATE WIDTH	RD. BK. VOL. PG.	DATE WIDTH	RD. BK. VOL. PG.	DATE WIDTH	
1	SOUTH RANGE RD.	S.H.89		TRA 28	1820 60	4 381	1936 60			Estab. S.H. Dec. 1936 Original Co. Rd. 26
2	Bassinger	127		1 26	1852 40					
*3	NEW BUFFALO RD.	125		TRA 40	1824	TRA 158	1836	TRA 203	1844	
4	MIDDLETOWN RD.	28				TRA 203	1844 60			
5	Blosser	131		TRA 186	1840					
6	SOUTH AVE. EXT.	S.H.502		TRA 4	1805 50	TRA 142	1834			
6	COLUMBIANA RD.	S.H.82		TRA 4	1805 50	TRA 142	1834			
7	MARKET ST. EXT.	S.H.502		TRA 11	1807 50	TRA 220	1844			
7	MARKET ST. EXT.	S.H.82		TRA 43	1828					S.R. 7 S.H. 502 *Estab. State Road by Legislature.
8	PINE LAKE RD.	20	3	2 44	1878 40					
9	LIPPLY RD.	60		TRA 184	1839					
10	Mah. Col. County Line	6		TRA 99	1830					
11	Van-Pelt	111		TRA 165	1836	4-A 113	1921 40			
11	Salem-Unity	S.H.86		TRA 165	1836					
11	Knopp	46		TRA 165	1836					
12	Germantown	113		1 111	1860 33					
13	Columbiana-Carfield	S.H.534		TRA 12	1807 50					
14	PINE LAKE RD.	20		1 179	1868 40	6 73	1958 60	Comm. Jr. 46 Pg. 185		
15	PINE LAKE RD.	20		1 5	1848 45					
16	Renkenberger	40		TRA 54	1826					
17	Green-Beaver	107		TRA 135	1834					
18	SOUTH RANGE RD.	S.H.89				1 2	1847	4 381	1936 60	Original Co. Rd. 26
19	MIDDLETOWN RD.	28		TRA 193	1843					
20	Lynd	50-A	31	TRA 150	1835	2 90	1881	Vac.		
			23	TRA 174	1838					
21	CALLA RD.	30		TRA 196	1843					
22	NEW BUFFALO RD.	125		1 14	1849					
23	Detwiler	115		TRA 156	1836					
24	Lynd	50-A		TRA 174	1838	1 223	1870	Vac.		
25	Western Reserve	32		TRB 254	1834			CSR 350	1886 40	Baun *Estab. State Road by Legislature.
26	CALLA RD.	30		TRA 188	1840	5 277	1952	ALT.		
27	Woodworth	S.H.832-153		TRA 2	1805 50	TRA 26	1819 50	4 383	1936 50	Est. Pt. S.H. Nov. 1936
28	Paulin	54		1 115	1861 40					
29	MIDDLETOWN RD.	28		TRA 211	1845					
30	SOUTH AVE. EXT.	S.H.502		TRA 114	1832					
31	Sharrott	143-B		1 11	1848 40					
32	NEW BUFFALO RD.	125		TRA 28	1820 60	1 199	1869 40			
33	SOUTH RANGE RD.	S.H.89		TRA 279	1825					
34	Garfield	8		TRA 85	1830					
35	Salem-Unity	S.H.86		TRA 21	1817 50					
36	Beaver-Springfield	149		TRA 170	1836					
40	Green-Beaver	107								
41	Garfield	8	47	2 155	1889 36	5 187	1952 50			
42	NEW BUFFALO RD.	125	124			3 121	1911 50			
43	Elton	143A	133	3 49	1911 30					
44	Cook	237	235			4 451	1942	Vac.		
*3	NEW BUFFALO RD.	125				1 14	1849	Pf Vac.		
45	Leshner	48								
46	EUREKA	129								
47	SHEELEY	141								
48	MILEY RD.	52								
49	Middletown Rd.	28	353	6 251	1960 60					

3

BERLIN TOWNSHIP ROAD RECORD INDEX TO ESTABLISHMENTS & VACATIONS

- ① Number on Road indicates Index Number.
- 50 Number over Road indicates Width of R. of W.
- Vacated Road

RANGE 5 - TOWNSHIP 1

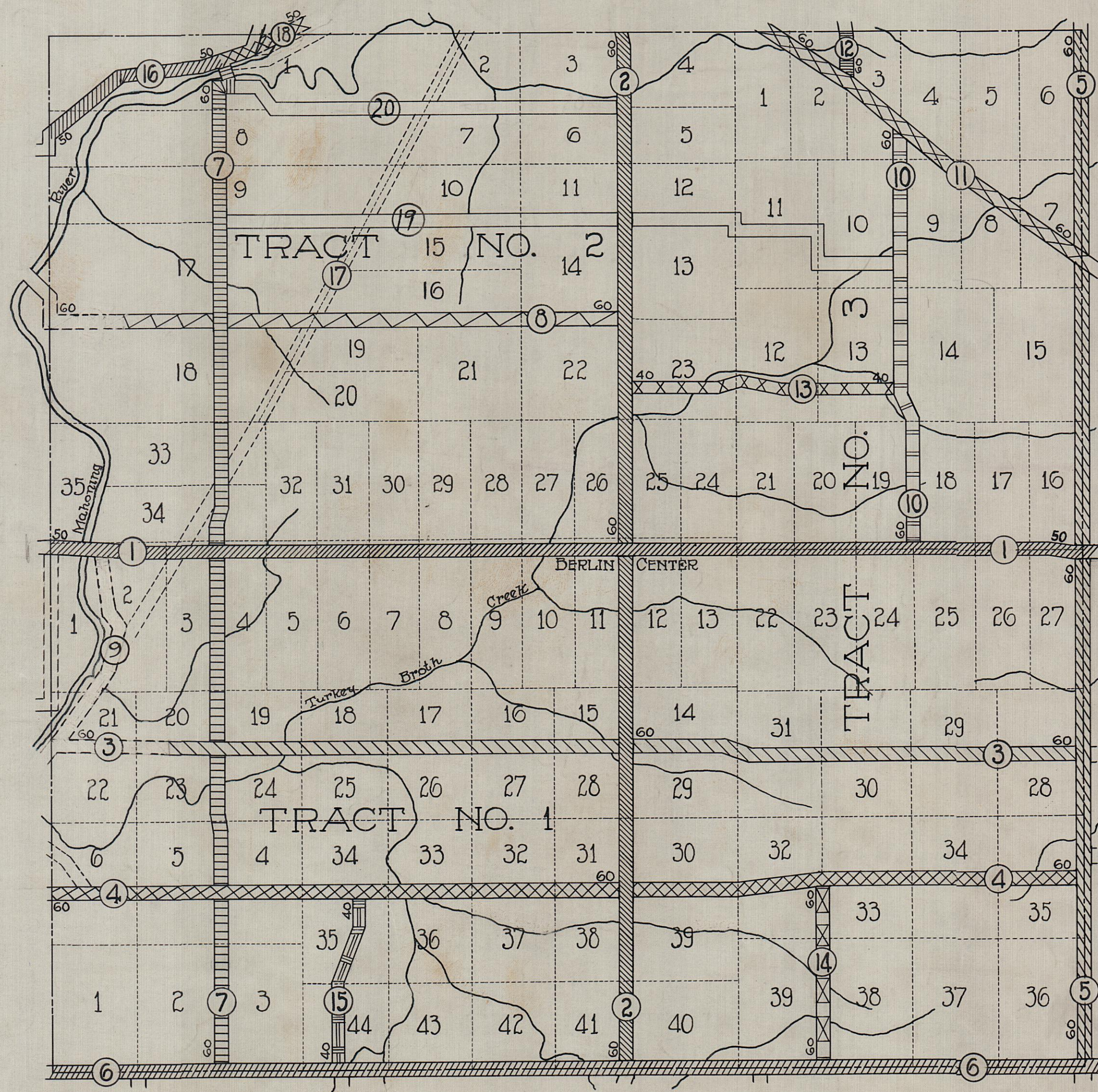

BERLIN TOWNSHIP ROAD RECORD INDEX TO ESTABLISHMENTS & VACATIONS

3

INDEX NO.	NAME OF ROAD.	COUNTY ROAD NO.	SURVEYOR FILE NO.	ESTABLISHED		ALTERED		ALTERED		REMARKS
				RD. BK. VOL. PG.	DATE WIDTH	RD. BK. VOL. PG.	DATE WIDTH	RD. BK. VOL. PG.	DATE WIDTH	
1	Akron-Carfield	SH 87		TRB 24	1805 50	4 191		Var.		VS 224
2	Damascus-Newton Falls Windsor	SH 919		TRB 128	1826 60	4 379	1937	60		Estab. SH. Apr. 1937 SR 534
3	Berlin Sta.	90		TRB 166	1830 60	4 479	1943	vac.		
4	Leffingwell	74	48-150	TRB 219	1833 60	4-A 9	1916	60		
5	DUCK CREEK RD.	53		TRB 211	1832					
				TRB 214	1832 60					
6	Western Reserve	32		TRB 254	1834					* Estab. State Road by Legislature.
7	Bedell	31		TRB 160	1829 60					* Estab. State Road by Legislature.
				TRB 250	1834					
8	Heiser	92		TRA 252	1843 60	4 491	1943	vac.		
9	Helsel	59		TRB 263	1835	4 495	1943	vac.		
10	Weaver	49		TRB 330	1839 60					
11	Ellsworth	116		TRB 51	1811 60					
12	NEWTON FALLS RD.	51		TRB 147	1828 60					
13	Hoyle	244		TRA 257	1844 40	4 430	1940			
14	Cook	47		TRB 290	1837 60					
15	Smith-Goshen	29	338	TRA 267	1846 40					Comp. Jr. Vol. 48 Pg 171 to 173 Vac.
16	Mill	114		TRB 65	1816 50					6 183 187 1960 Vacation
17	Fields	41		TRA 231	1819 60	3 289	1917	vac.		
18	Mill	114	100			2 378	1904	50	CSR 438	1904 50
						3 301	1919			
	Mahoning-Portage Cty	3 B				4 499	1943	vac.		
19	Mock	66								
20	SHILLING	112								

CANFIELD TOWNSHIP ROAD RECORD
INDEX TO ESTABLISHMENTS & VACATIONS

⑧ Number on Road indicates Index Number.
50 Number over Road indicates Width of R. of W.
- - - - - Vacated Roads

RANGE 3 - TOWNSHIP 1

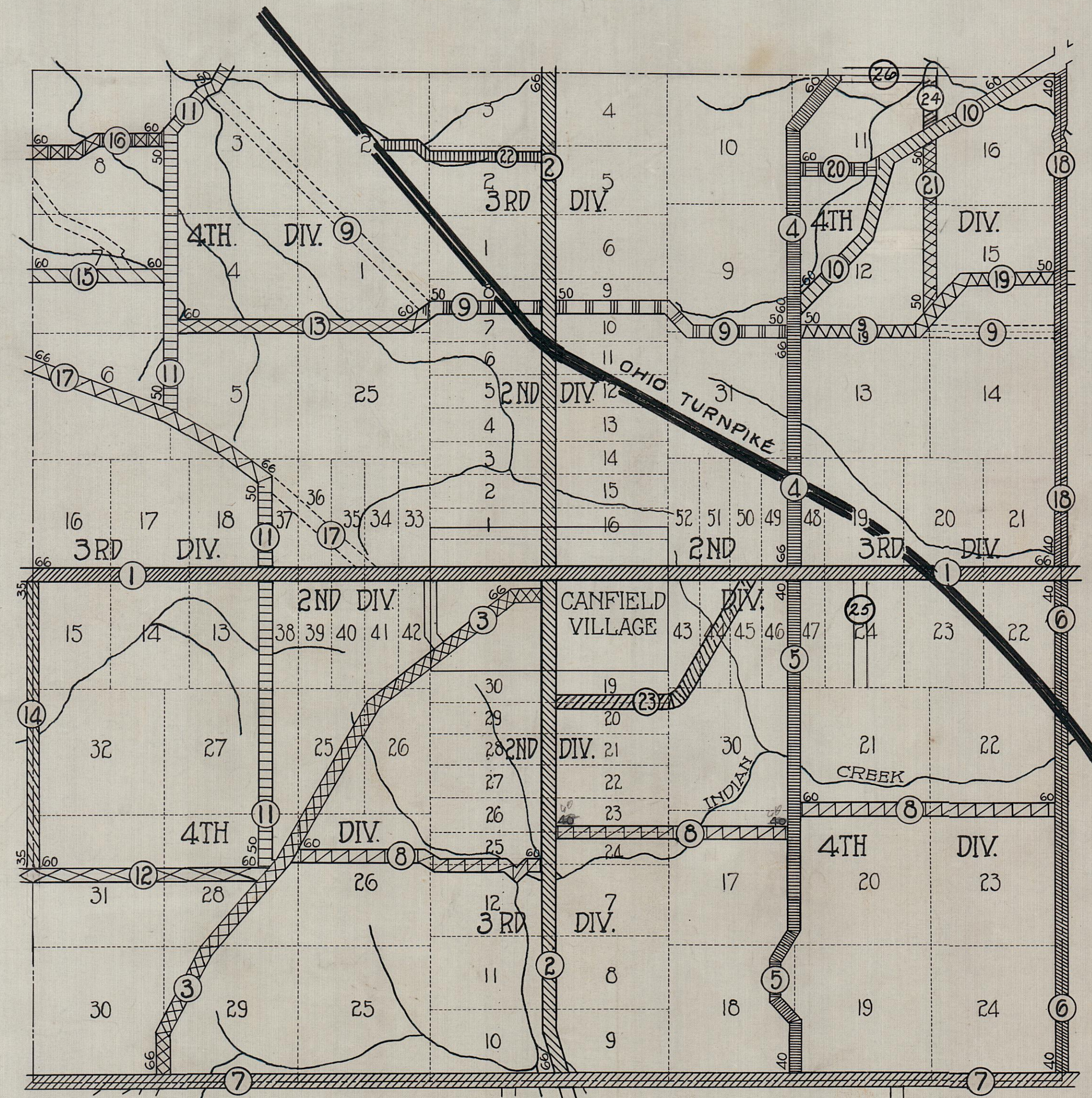

CANFIELD TOWNSHIP ROAD RECORD
INDEX TO ESTABLISHMENTS & VACATIONS

INDEX NO.	NAME OF ROAD.	COUNTY ROAD NO.	SURVEYOR FILE NO.	ESTABLISHED		ALTERED		ALTERED		REMARKS
				RD BK. VOL. PG.	DATE WIDTH	RD BK. VOL. PG.	DATE WIDTH	RD BK. VOL. PG.	DATE WIDTH	
1	Canfield-Poland	S.H.486		TRB 12	1803 66			CSR 426	1900 66	US 224
	Akron-Canfield	S.H.07		TRB 12	1803 66			CSR 426	1900 66	US 224 SR14
2	Canfield-Niles	S.H.328		TRB 12	1803 66	TRB 106	1825 66			* Estab. State Road by Legislature
	Columbiana-Canfield	S.H.534		TRB 12	1803 66	TRB 106	1825 66	4	429 1941 66	* Estab. State Road by Legislature
3	Youngstown-Salem	S.H.81		TRB 19	1804 66	3	345	Var.		US 62
4	Racoon	109	264	TRB 14	1803 66	TRB 77	1820 60	CSR 403		5-259-1952-ALT.
5	Racoon	109		TRB 14	1803 66	1	189 1868 66	1	217 1870 40	
*6	Tippecanoe	117	223	TRB 345	1840 60	1	94 1858 60	1	148 1863 40	New Buffalo-Riblets
7	Western Reserve	32	27	TRB 254	1834	2	91 1881			* Estab. State Road by Legislature.
8	Leffingwell	74		TRB 206	1832 60	1	225 1870 40	6	ES 1958 60	
9	Youngstown-Salem	S.H.81		TRB 29	1807 50	TRB 240	1834	Vac.		US 62
10	Youngstown-Salem	S.H.81		TRB 47	1811 60					US 62
11	Turner Rd.	103		TRB 32	1807 50					TURNER SCH-OHLTOWN
17	PALMYRA RD	136		TRB 32	1807 50					CANFIELD-PALMYRA
12	Leffingwell	74		TRB 84	1822 60					
13	Herbert	110	222	TRB 53	1811 60	4	420 1938			Infirmary
14	Croxy	93	22	2	61 1880 35					
15	Herbert	110	222	TRB 74	1819 60	4	420 1938			Infirmary
16	Gibson	118		TRB 64	1816 50	TRB 80	1822 60	TRB 107	1824 60	
17	PALMYRA RD.	136		TRB 10	1802 66	TRB 43	1810	Vac.		CANFIELD-PALMYRA
18	Tippecanoe	117	223	TRB 42	1809 66	1	151 1864 40	1	159 1866	New Buffalo-Riblets
						3	433 1917 40	CSR 458	1917 40	
19	Shields Rd.	100	161	4	61 1925 50					SHIELD-TITUSVILLE
20	Mellinger	253	156	4-A	81 1925 60					
21	Messery	257	200	4	127 1930 50	4	404 1938 50			
22	Gibson	118	181	4	311 1932 30	4	359 1939			
23	Fairground Blvd.	273	219	4	360 1937 60-80					
24	BURGESS LANE	257	227	4	404 1938 50					MESSERLY
25	Summit	278		4	466 1943 50					
26	Burgess	279		4	461 1943 60					
*6	Tippecanoe	117				4	418 1938	4	431 1941	New Buffalo-Riblets

6

COITSVILLE TOWNSHIP ROAD RECORD
INDEX TO ESTABLISHMENTS & VACATIONS

- ① Number on Road indicates Index Number.
- 50 Number over Road indicates Width of R of W.
- Vacated Roads

RANGE 1 - TOWNSHIP 2

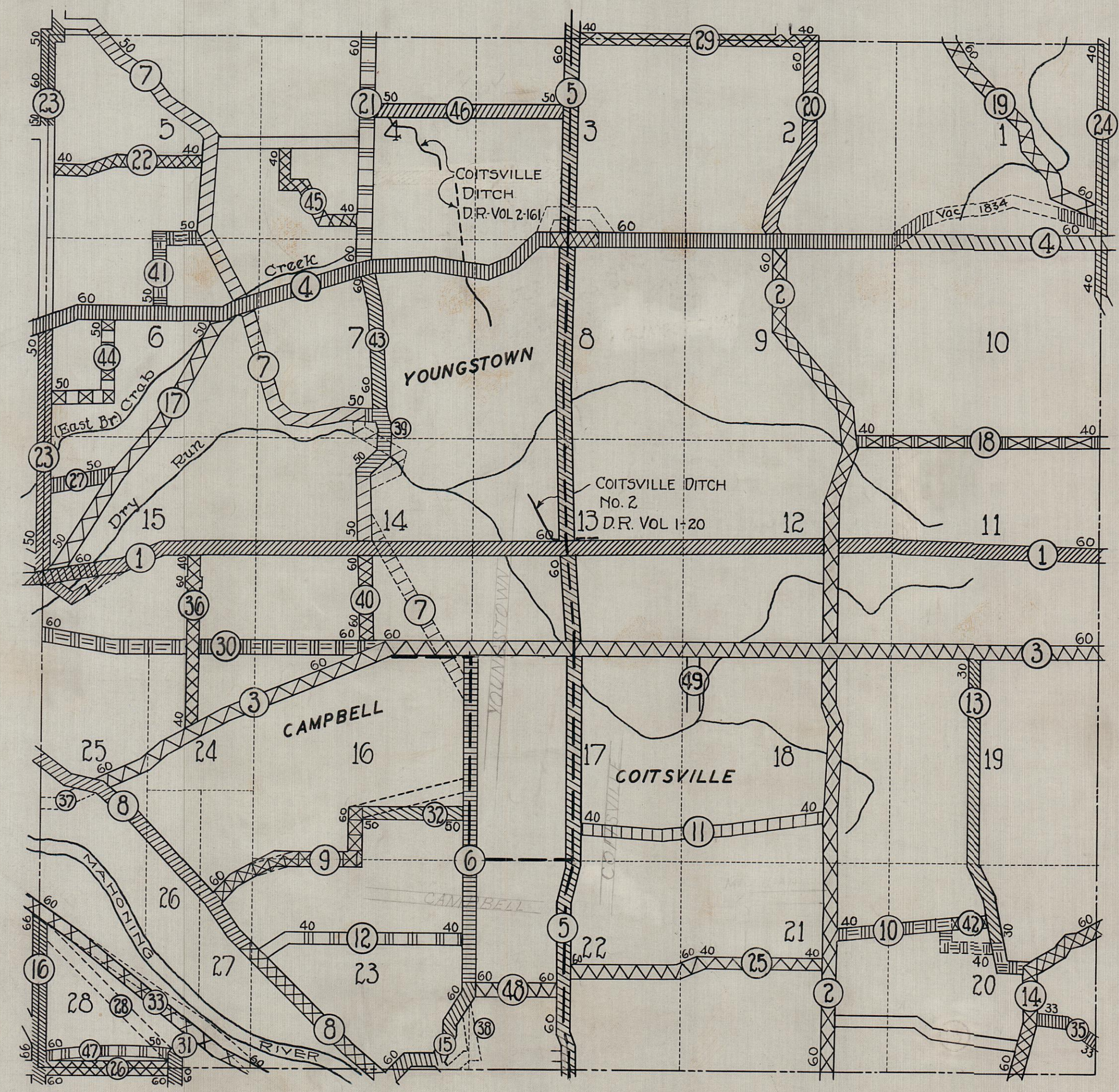



6

COITSVILLE TOWNSHIP ROAD RECORD
INDEX TO ESTABLISHMENTS & VACATIONS

INDEX-NO	NAME OF ROAD.	COUNTY ROAD NO.	SURVEYOR FILE NO.	ESTABLISHED		ALTERED		ALTERED		REMARKS
				RD BK VOL PG	DATE WIDTH	RD BK VOL PG	DATE WIDTH	RD BK VOL PG	DATE WIDTH	
1	Oak Street	170	188	TRB 275	1836 60	2 22	1874	4A 1	1916 60	
2	HUBBARD RD	219		TRB 134	1827 60					Low - HUB
3	M ^c CARTNEY RD.	85		TRB 4	1801 66	TRB 185	1830 60	CSR 457	1912	Yo - N. BED. Also Vol. 9 Pg. 435 US 422
4	M ^c Guffey	172	4	TRB 60	1814	TRB 233	1834 60	TRA 236	1841 60	
5	POLAND - HUBBARD	S.H.958	13	TRB 142	1828 60	TRB 2 86	1878 60	CSR 428	1900 60	
				TRB 197	1831	2 477	1879 60	CSR 376	1887 60	Pt. - CO. ROAD 199 *Etab. State Road by Legislature. SR 46
6	LIBERTY RD	185								STRU - LIB
7	LIBERTY RD	185	96	TRB 57	1813	1 127	1862 50	1 162	1867 50	"
8	Youngstown-Lowellville	S.H.14	61	TRB 17	1804 66	2 128	1885 50-40	CSR 439	1902	SR 289 Etab. State Road by Legislature.
				TRB 85	1823 60			CSR 323	1885	
9	Warhurst	130		TRA 240	1842 60					
10	Villa Marie	152		1 10	1848 40					
11	Cooper	132		1 71	1854 40	6 257	1969 60			
12	Robinson	148		2 32	1875 30	2 433	1910 40			
13	BEDFORD RD.	223		1 166	1867 30					Low - BED.
14	BEDFORD RD.	223-152		TRB 195	1831 60					Pt. Villa Marie Rd.
15	BRIDGE ST.	S.H.958	89			1 44	1853 40	1 53	1854 60	Original Co. Rd. 185
						2 248	1901 60	4 371	1938 60	Etab. S.H. Feb. 1938
16	LOVELAND	S.H.83		TRB 8	1802 66					Yo - PIT
17	Early	183	117422	1 74	1854 35	2 385	1909 50	2 418	1910 50	
18	Johnson	174		1 17	1851 40					
19	JOHN WHITE RD.	229		TRB 228	1834 60	COMM.	JR. Vol. 48 Pg. 93-95			HUB - N. BED
20	HUBBARD RD.	219		TRB 222	1833 60					LOW - HUB
21	Jacobs	187		TRB 270	1836 60					
22	ATKINSON	186	146	1 207	1870 33	3 229	1914 40			THORN HILL
23	LANSDOWN BLVD.	171	48	2 160	1889 50			1 81	1855	Vac. BOND
			68	2 168	1891 50-60			CSR 364	1887	
24	Ohio-Penna State Line	5	28	2 73	1882 40			CSR 191		
25	Villa Maria	152		TRB 335	1838 60	2 96	1875 40			
26	Midlothian Blvd.	138		TRB 49	1811 60					
27	EAST HIGH AVE.	194		2 26	1875 50					EMMA ST.
28	Loveland			TRB 33	1808 50	TRA 228	1818 Vac.	TRB 68	1818 Vac.	
29	Mahoning-Trumbull Co. Line	4		TRA 260	1845 40					
30	M ^c Cartney	S.H.85	130-121	3 13	1909 60	3 23	1910 60			US 422
31	WALTON	197	129	2 413	1910 60					LYON
32	TENNY	130	98-134			2 265	1902 50	3 155	1911 Vac.	WARHURST
			152			3 165	1916 60			
33	Poland Av-Strutlers-Lowellville	196	176			2 435	1910 60	3 179	1913 60	
34										
35	Houston	134	86	2 201	1899 33			CSR 421	1899 33	(McBRIDE RD.)
36	Cort	173	85	2 211	1899 40-60			CSR 418	1899	
37	Cover		175			2 262	1902 Vac.			
38	Van Auken		110	2 354	1908 50					
39	JACOBS	185	180			2 468	1910 50			STR - LIB
40	JACOBS	185	196	3 409	1918 60					"
41	Gray Ave.	238	192	4-A 57	1917 50					

7

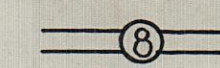
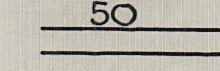
ELLSWORTH TOWNSHIP ROAD RECORD
INDEX TO ESTABLISHMENTS & VACATIONS

-  Number on Road indicates Index Number.
-  Number over Road indicates Width of R.of W.
-  Vacated Roads

RANGE 4 - TOWNSHIP 1

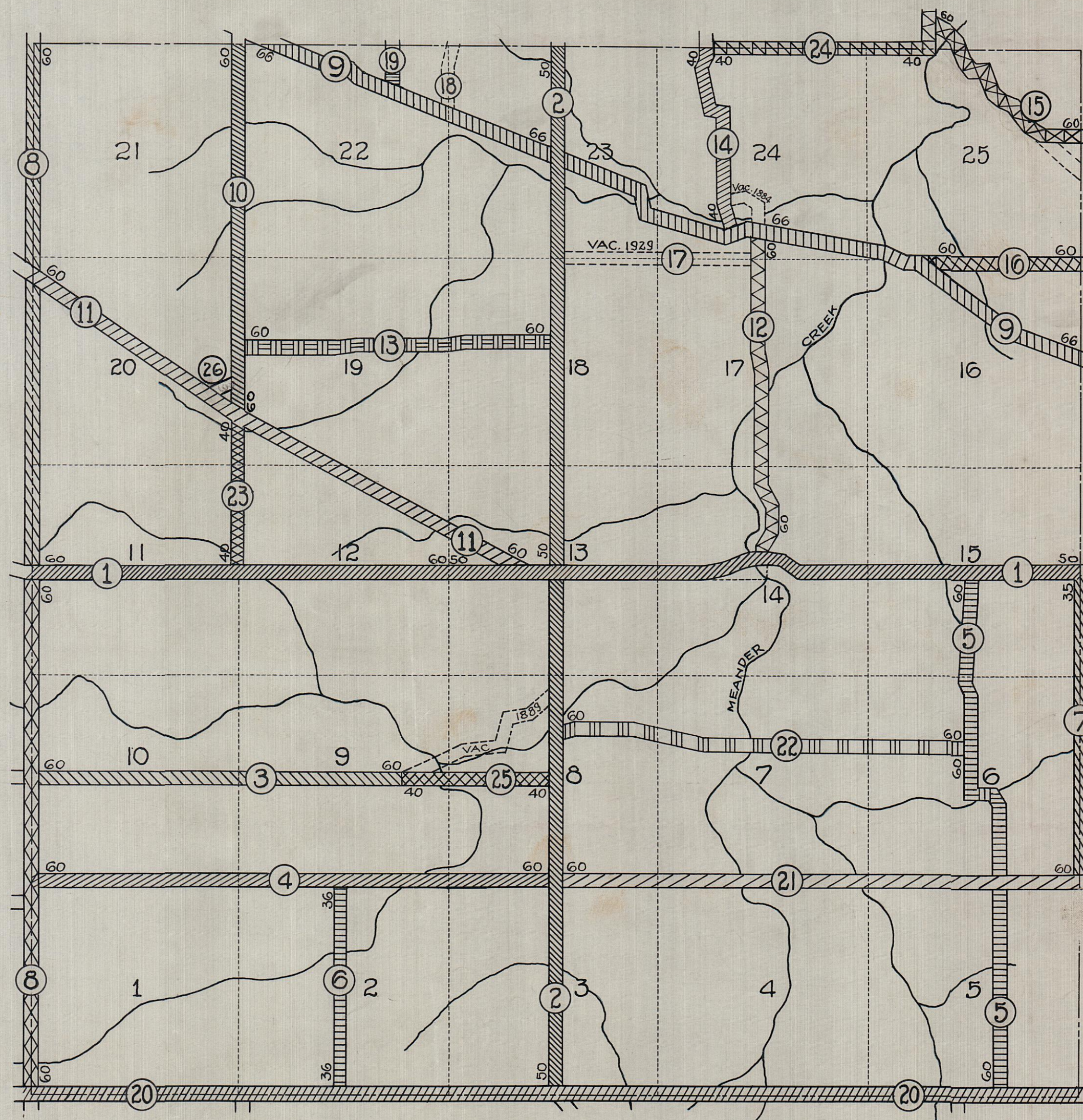

7

ELLSWORTH TOWNSHIP ROAD RECORD
INDEX TO ESTABLISHMENTS & VACATIONS

INDEX NO.	NAME OF ROAD.	COUNTY ROAD NO.	SURVEYOR FILE NO.	ESTABLISHED			ALTERED			ALTERED			REMARKS	
				RD. BK. VOL. PG.	DATE	WIDTH	RD. BK. VOL. PG.	DATE	WIDTH	RD. BK. VOL. PG.	DATE	WIDTH		
1*	Akron-Canfield	S.H.87		TRB 24	1805	50	TRB 36	1808	50	1	109	1860	60	US 224 SHH
2	Salem-Warren	S.H.516	15	TRB 30	1808	50	2	81	1880	50	4	235	1929	Var. SR 45
3	BERLIN STA. RD.	90		TRB 243	1834	60	4	430	1941					BER STA - ELLS. L.
4	Leffingwell	74		TRB 98	1824	60								
5	Knauf	75		TRB 121	1825	60								
6	Huxley	63		1	100	1860	36							
7	Crory	93	22	2	61	1880	35							
8	DUCK CREEK RD.	53		TRB 211	1832		TRB 214	1832	60					GOS. CTR - DUCK CR
9	PALMYRA RD.	136		TRB 10	1802	66	TRB 203	1832	60	4	425	1940		CANFIELD - PAL
10	BAILEY RD.	65		TRB 97	1824	60				CSR 415	1891			ELLS STA - BAIL. COR
11	ELLSWORTH RD.	116		TRB 51	1811	60								ELLS - PALMYRA
12	Gault	73		TRB 121	1825	60								
13	Diehl	246		TRB 114	1825	60								
14	Gault	73	34	TRB 56	1813		2	122	1884	40	CSR 283	1884		
			35	1	7	1848	40				CSR 297	1885		
15	Gibson	118	216	TRB 64	1816	50	TRB 80	1822	60	4	358	1939	60	
16	Herbert	110	222	TRB 74	1819	60	4	420	1938					INFIRMARY
17	Leonard	108	168	TRB 348	1840		4	119	1929	Vac.				
18	Ripley			TRB 46	1811	60								
19	Rosemont	67		TRA 244	1843									ROSEM - N JACK
20	Western Reserve	32		*TRB 254	1834									* Estab State Road by Legislature
21	Leffingwell	74		TRB 84	1822	60	4	432	1940	VAR				
22	BERLIN STA. RD.	90		TRB 163	1830	60								BER STA - ELLS. L.
23	BAILEYS RD.	65	132	3	61	1911	40			CSR 276	1884			ELLS STA - BAIL. COR
24	Gibson	118	139	3	205	1912	40	3	305	1912	40			
25	BERLIN STA. RD.	90	46-49	2	148	1889	40			CSR 404	1889	40		BER STA - ELLS. L.
26	ELLSWORTH STA CUT-OFF	274	220	4	338	1938	60							
1*	Akron-Canfield	S.H.87					4	191		Var.				

8

GOSHEN TOWNSHIP ROAD RECORD INDEX TO ESTABLISHMENTS & VACATIONS

⑧ Number on Road indicates Index Number. ----- Vacated Roads
50 Number over Road indicates Width of R.of W.

RANGE 4 TOWNSHIP 17

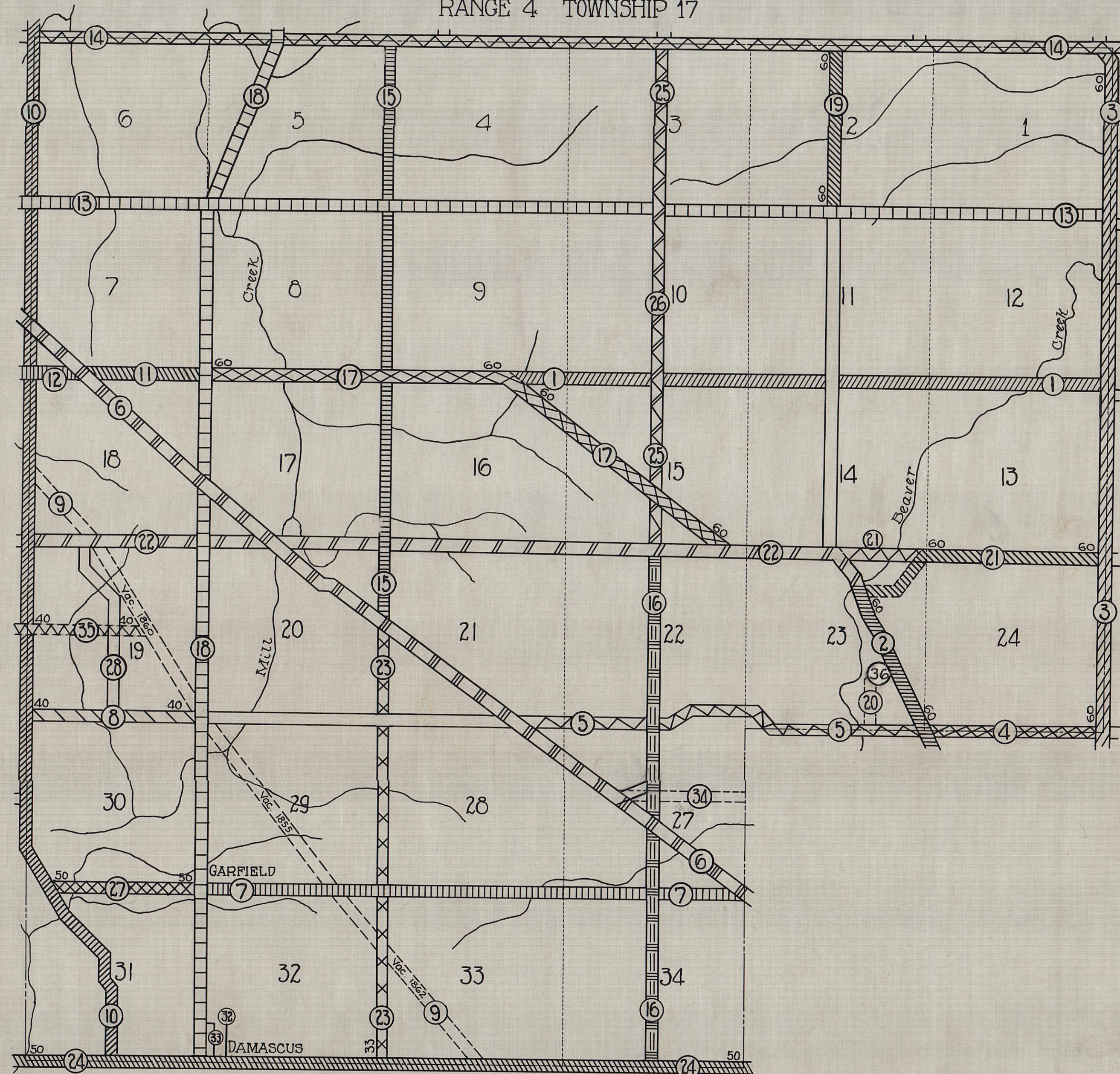

8

GOSHEN TOWNSHIP ROAD RECORD INDEX TO ESTABLISHMENTS & VACATIONS

INDEX NO.	NAME OF ROAD	COUNTY ROAD NO.	SURVEYOR FILE NO.	ESTABLISHED			ALTERED			ALTERED			REMARKS
				RD BK VOL PG	DATE	WIDTH	RD BK VOL PG	DATE	WIDTH	RD BK VOL PG	DATE	WIDTH	
1	MIDDLETOWN RD.	28		TRA 112	1832	60							SNODES - N MIDDLE.
2	GOSHEN RD.	61		TRA 14	1807	33	TRA 18	1815	60	TRA 201	1844		STRATTON
3	Salem-Warren	S.H.516		TRA 15	1811	60	4 235		Var.				SR 45
4	PINE LAKE RD.	20		TRA 95	1831	60							SEBRING - P. LAKE
5	PINE LAKE RD.	20		TRA 89	1830	60	TRA 146	1834	60				"
6	Cleveland-East Liverpool	S.H.12		TRA 46	1807	60	4 250	1930	Var.	4 249	1928	Var.	SR 147 14
7	GARFIELD RD.	8		TRA 132	1834	60							GAR - PETERSBURG
8	PINE LAKE RD.	20		1 122	1861	40							SEBRING - P. LAKE
9	Deerfield-New Lisbon						1 84	1855	Vac.	1 104	1860	Vac.	
10	Smith-Goshen	29		TRA 127	1833	60							
11	MIDDLETOWN RD.	28		TRA 64	1829	60							SHODES - N. MIDDLE
12	MIDDLETOWN RD.	28		TRA 86	1830	60							"
13	CALLA RD.	30		TRA 60	1829	60							NO BEN. - CALLA S.L.
14	Western Reserve	32		TRB 254	1834	60							* Estab. State Road by Legislature.
15	Seacrist	45		TRA 97	1831	60							
16	DUCK CREEK RD.	53		TRA 93	1830	60				4 250	1930	60	Gos CTR - DUCK CR.
17	DIAGONAL	55-28		TRA 20	1817	60							GOSHEN CENTER DIAG
18	Damascus-Newton Falls-Windsor	S.H.919		TRA 62	1829	60	TRA 285	1815	50	4 379	1937	50	Estab. S.H. Apr. 1937 Original Co. Rd. 39
19	Stratton	61		TRA 145	1834	60	TRA 200	1843	Vac.				SR 53 4
21	SOUTH RANGE RD.	S.H. 89	104	TRA 36	1824	60	2 298	1906	60	4 381	1936	60	Estab. S.H. Dec. 1936
22	SOUTH RANGE RD.	S.H. 89		TRA 120	1833	60				4 381	1936	60	Original Co. Rd. 26
23	Seacrist	45		1 132	1862	33							
24	Alliance-Salem	S.H.84		TRA 10	1806	50	TRA 40	1828					US 62
25	DUCK CREEK RD.	53		TRA 38	1824	60							GOSHEN CTR - DUCK CREEK
26	DUCK CREEK RD.	53		TRA 140	1834	60							
27	Garfield	8	84	2 241	1899	50				CSR 417	1899	50	Township Road
28	Malmsberry	43											
29													
30													
31													
32	Haines			2 145	1888	60							
33	French Street	272	184	4 145	1932	50-60							
34	Shrives			TRA 91	1830								
35	Courtney	22		TRA 34	1822	40							Not Oper.
36	KENT RD.	57											

JACKSON TOWNSHIP ROAD RECORD
INDEX TO ESTABLISHMENTS & VACATIONS

⑧ = Number on Road indicates Index Number
50 = Number over Road indicates Width of R. of W.

RANGE 4 - TOWNSHIP 2

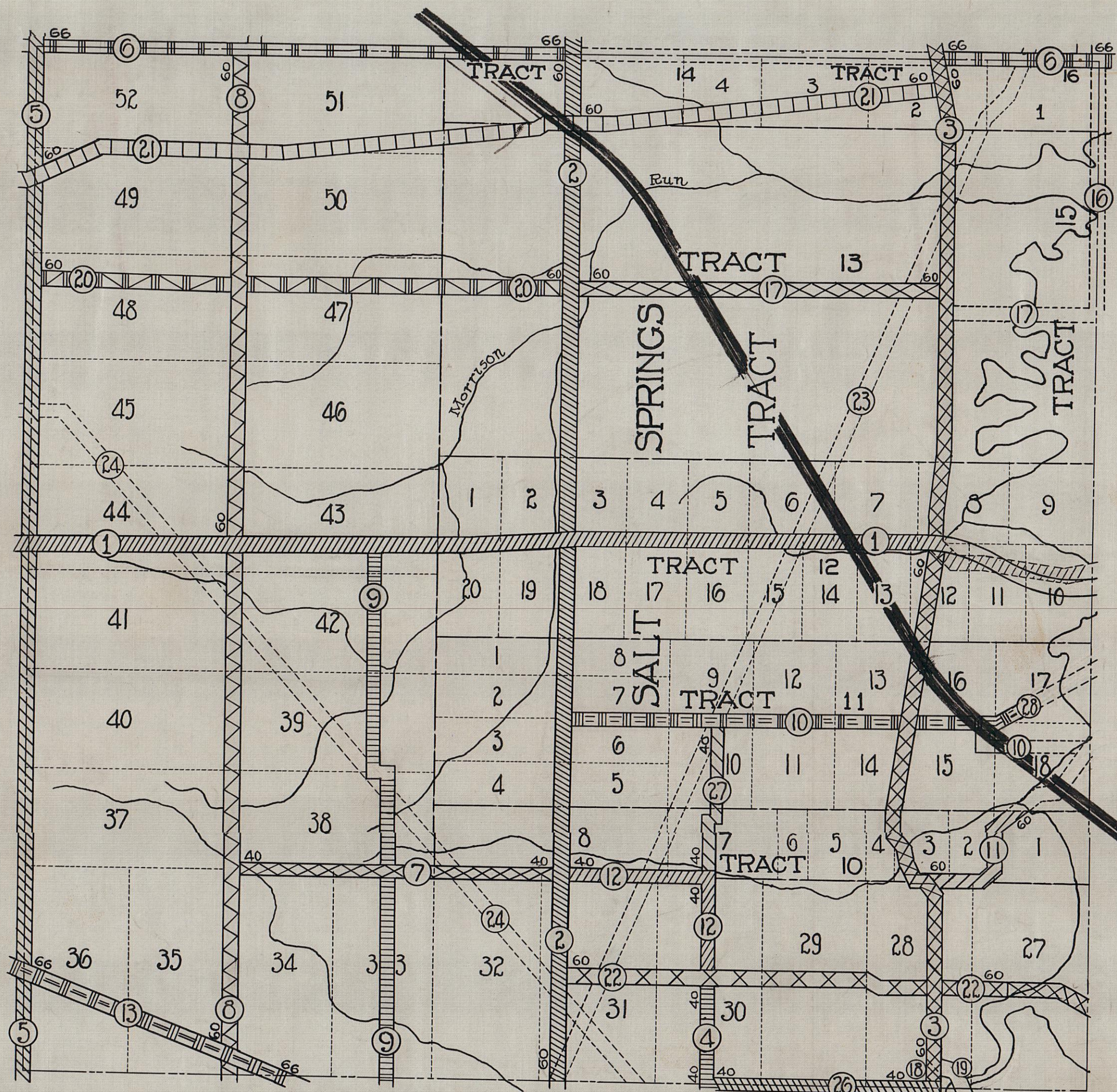

JACKSON TOWNSHIP ROAD RECORD
INDEX TO ESTABLISHMENTS & VACATIONS

INDEX NO	NAME OF ROAD	COUNTY ROAD NO.	SURVEYOR FILE NO.	ESTABLISHED		ALTERED		ALTERED		REMARKS
				RD BK VOL PG.	DATE WIDTH	RD BK VOL PG.	DATE WIDTH	RD BK VOL PG.	DATE WIDTH	
1	Akron-Youngstown	S.H.18		TRB 37	1807	4 162A	1932	Var.		SR 18
2	Salem-Warren	S.H.516		TRB 91	1823 60	4 240		Var.		SR 45
3	Lipkey	91		TRB 139	1828 60	TRB 308	1837 60			PIERSOL RD.
4	Gault	73		1 7	1848 40					
5	Duck Creek Rd.	53		TRB 211	1832					
6	Mah-Trumbull Co. Line	4		TRB 5	1802 66	TRB 333	1839			
7	Blott	160		TRB 287	1837 60	1 118	1861 40			
8	Baileys Rd.	65		TRB 246	1834 60					
9	Rosemont	67		TRA 244	1843					
10	New	162		TRB 338	1840	4 253	1929	Vac.	4 163 1932	Variable
11	Shaffer	128	203	TRB 322	1838 60	4 229	1929	Vac.		
12	Blott	160		1 19	1851 40					
12	Gault	73		1 19	1851 40					
13	Palmyra Rd.	136		TRB 10	1802 66					
16	Vandivort	93	204	TRA 232	1841 60	4 265	1929	Vac.		
17	Silica Rd.	178		TRB 177	1830 60	4 241	1929	Vac.		
18	Lipkey	91		1 4	1847 40					
19	Gibson	26	216	TRB 80	1822 60	1 4	1847 40	4 358 60	1939	
20	Silica Rd.	178		TRB 236	1834 60					
21	Gladstone	190		TRB 76	1819 60					
*22	Kirk	146	202	TRB 156	1829 60	1 102	1860 30	CSR 448	1904	
23	Diagonal			TRB 30	1808 50	TRB 139	1828	Vac.		
24	Morrison			TRB 56	1813	TRB 211	1832	Vac.	TRB 280 1836	Vac.
25	Riddle Mill-Newton Falls			TRB 39	1809					
26	Gibson	118	139	3 205	1912 40					
27	Gault	73	78	2 181	1896 40	5 205	1953 60			
28	Fairview	166				4 181	1929	Vac.	5 327 1953	Vac.
*22	Kirk	146				4 326A	1936 60			
*22	Kirk	146	202			4 205	1929	Vac.	4 325 1934 60	Estab. S.H. Nov. 1936

MILTON TOWNSHIP ROAD RECORD
INDEX TO ESTABLISHMENTS & VACATIONS

⑥ Number on Road indicates Index Number.
50 Number over Road indicates Width of R. of W.
--- Vacated Roads

RANGE 5 - TOWNSHIP 2

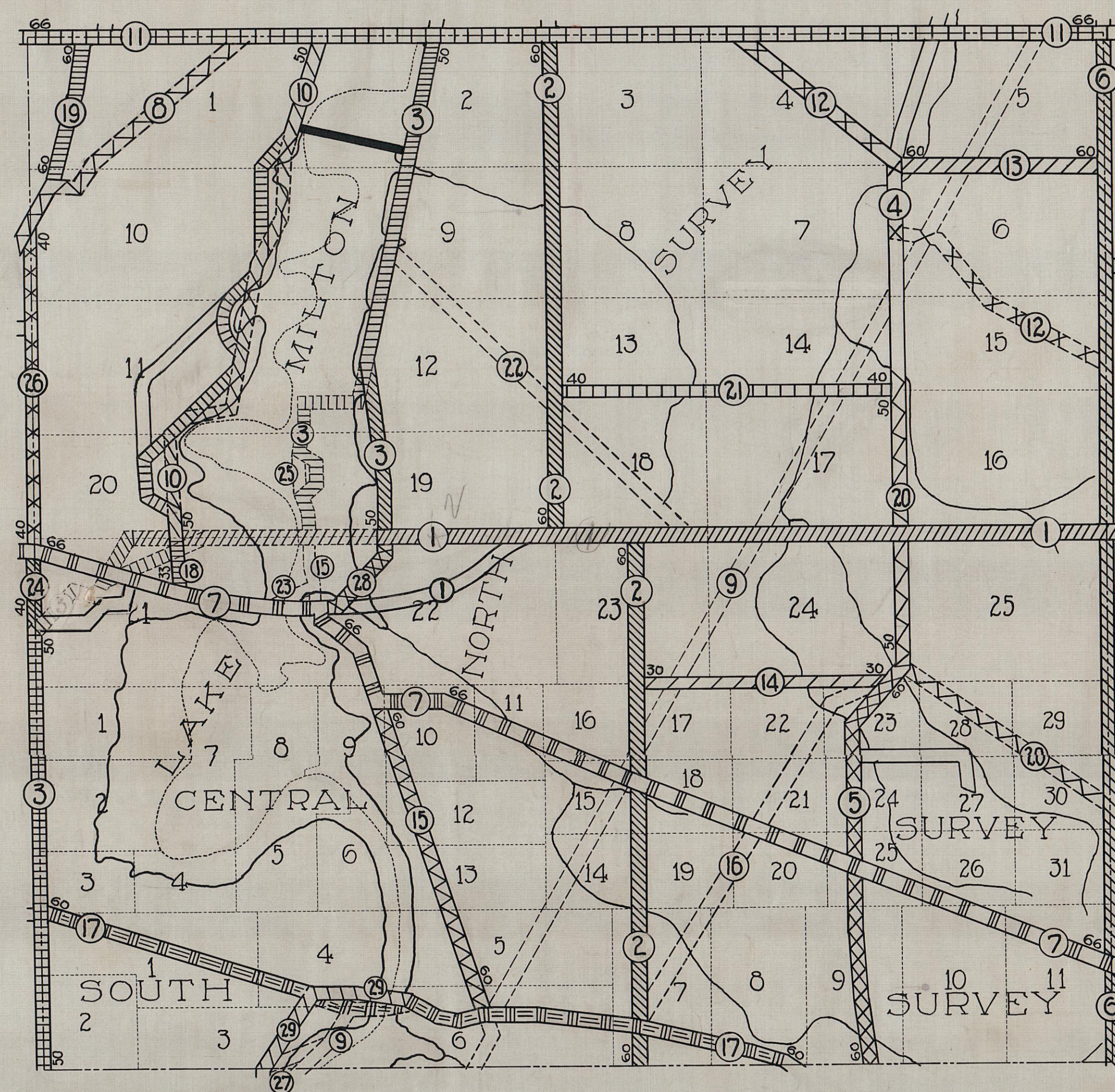

MILTON TOWNSHIP ROAD RECORD
INDEX TO ESTABLISHMENTS & VACATIONS

INDEX NO.	NAME OF ROAD.	COUNTY ROAD NO.	SURVEYOR FILE NO.	ESTABLISHED		ALTERED		ALTERED		REMARKS
				RD BK VOL PG	DATE WIDTH	RD BK VOL PG	DATE WIDTH	RD BK VOL PG	DATE WIDTH	
1	Akron-Youngstown	S.H.18	213	TRB 37	1807	4 369	1937	Var:		SR 18
2	PRICETOWN Rd.	37		TRB 342	1840 60					
2	Damascus-Newton Falls-Windsor	S.H.919		TRB 342	1840 60	4 379	1937	50		Estab. S.H. Apr. 1937 and 1939
*3	EAST RIVER RD.	S.H.919	79-193	TRB 37	1808 50	2 199	1896	Vac.	3 337	1919
3	Mahoning-Portage Co. Line	3		TRB 37	1808 50					
4	NEWTON FALLS Rd.	51								
5	NEWTON FALLS Rd.	51		TRB 147	1828 60					
6	DUCK CREEK Rd.	53		TRB 211	1832					
*7	PALMYRA Rd.	136		TRB 10	1802 66	3 313	1919		4 1628	1932 66
8	Hover			TRB 53	1812					PT. S.H. 18 Not Open
9	Mill	114	100	TRB 65	1816 50	2 378	1904 50		3 301	1919
				TRB 250	1834					
10	GRANDVIEW BLVD.	33	195	TRB 60	1815	1 146	1863		3 325	1918 50
				TRB 70	1818 50				3 331	1924 50
11	Mah-Trumbull Co. Line	4		TRB 5	1802 66					
12	Robinson	150		TRB 56	1813	TRB 211	1832	Vac.		
13	Gladstone	190	62	TRB 76	1819 60	2 126	1885 60	CSR 309	1885	
14	Stoltz	158		1 137	1862 30					
15	East River	35	190	TRA 231	1819 60	3 313	1919	Vac.		
16	Diagonal			TRB 128	1826 60					
17	Ellsworth	116	100	TRB 51	1811 60	3 301	1919			
18	GRANDVIEW BLVD.	33		1 191	1869 33					Platted 50 Ft.
19	MILTON-NEWTON FALLS	3-D		TRB 118	1825 60					
20	NEWTON FALLS Rd.	51		TRB 67	1818 50	TRB 147	1828	Vac.		
21	Creed	176		TRB 95	1823 40	4 430	1941			
22	Diagonal					1 56	1854	Vac.		
23	Carson		190	1 186	1868 60	3 313	1919	Vac.		
24	Mahoning-Portage Co. Line	3-C	70	2 164	1891 40					
25	East River	35	93			2 251	1901 50			
26	Mah-Portage Co. Line	3-C	106	2 332	1907 40					
27	Mill	114				2 378	1904 50			
28	EAST RIVER RD.	294	190			3 313	1919		4 379	1937 50
29	Ellsworth	116-114	100			3 301	1919			PARK DR. COMM. J.R. Vol 50 P. 471-68
*7	PALMYRA Rd.	136				4 379	1937 50			
*3	EAST RIVER RD.	S.H.919				4 379	1937 50	COMM. J.R. Vol 50 P. 471-68		Estab. S.H. Apr. 1937

RETURNED TO COUNTY OCT. 5, 1967
VOL. 52 - PG. 873
JOURNAL OF THE DIRECTOR OF HIGHWAYS

RETURNED TO COUNTY OCT. 5, 1967
VOL. 52 - PG. 873
JOURNAL OF THE DIRECTOR OF HIGHWAYS

PARK DR. COMM. J.R. Vol 50 P. 471-68

POLAND TOWNSHIP ROAD RECORD
INDEX TO ESTABLISHMENTS & VACATIONS

③ Number on Road indicates Index Number.
50 Number over Road indicates Width of R. of W.

RANGE 1 - TOWNSHIP 1

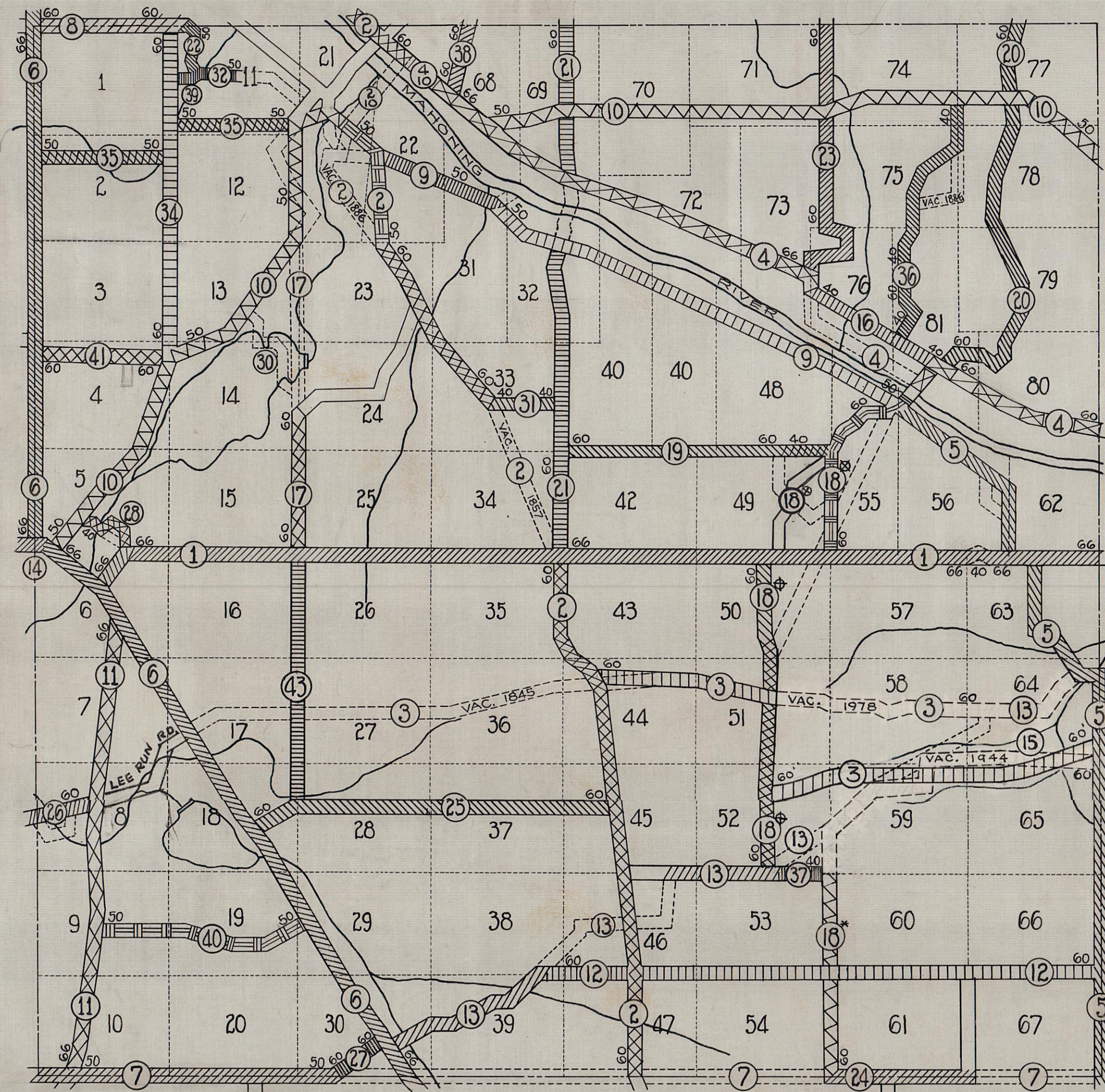

13

SMITH TOWNSHIP ROAD RECORD INDEX TO ESTABLISHMENTS & VACATIONS

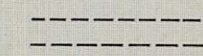
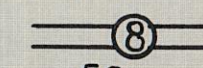
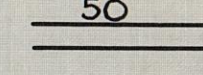
-  Vacated Road
-  Number on Road indicates Index Number.
-  Number over Road indicates Width of R. of W.

RANGE 5 - TOWNSHIP 18

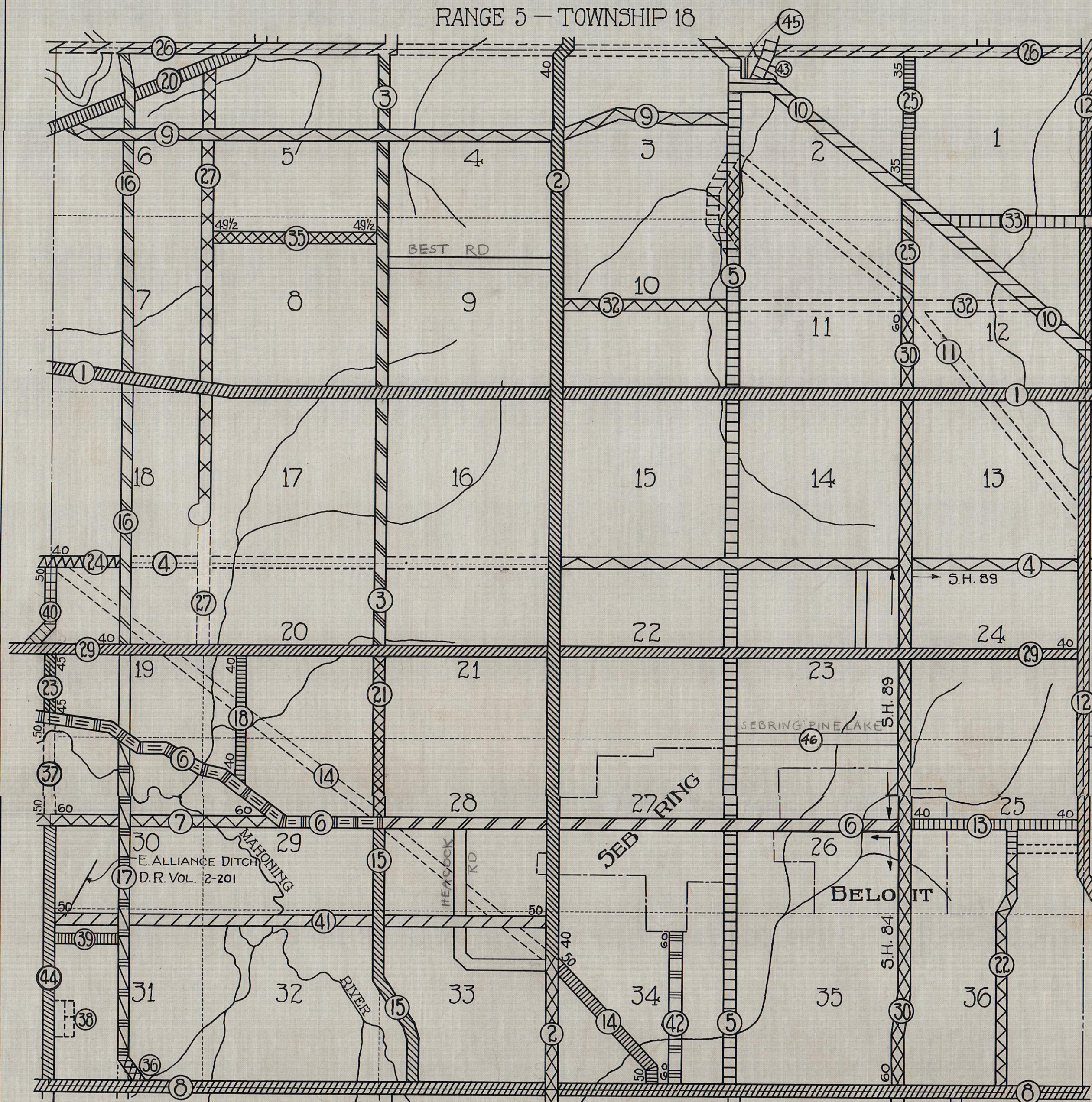

13

SMITH TOWNSHIP ROAD RECORD INDEX TO ESTABLISHMENTS & VACATIONS

INDEX NO.	NAME OF ROAD.	COUNTY ROAD NO.	SURVEYOR FILE NO.	ESTABLISHED		ALTERED		ALTERED		REMARKS					
				RD. BK. VOL. PG.	DATE WIDTH	RD. BK. VOL. PG.	DATE WIDTH	RD. BK. VOL. PG.	DATE WIDTH						
1	MIDDLE TOWN Rd.	28		TRA 86	1830										
2	JOHNSON Rd.	19		TRA 33	1822	40									
3	Bandy	17		TRA 74	1828										
4	South Range	26-SH89		TRA 110	1832										
5	Twelfth Street	23		TRA 120	1833	4	381	1936	60	Est. Pt. S.H. Dec. 1936					
6	Alliance-Salem	SH64		TRA 154	1836	1	29	1852							
7	LEXINGTON Rd.			TRA 79	1829										
8	Alliance-Salem	SH84	198	TRA 102	1831					S.R. 173					
9	MAHONING-COLUMBIANA C.L.	SH469		TRA 236	1872	60				U.S. 62					
10	North Benton West	68		TRA 52	1825										
11	Cleveland-East Liverpool	SH12	212	TRA 40	1828										
12	Deerfield-New Lisbon			TRA 40	1828										
13	Smith-Goshen	29		TRA 77	1829										
14	Beloit East	10		TRA 46	1807	TRB 263	1835	4	251	1935	Var. S.R. 114				
15	Hancock Rd.	21	244	TRA 1	1805	50	1	104	1860	Vac.	1	164	1867	Vac.	* Estab. State Road by Legislature.
16	Bandy	17		TRA 127	1833										
17	Beloit East	10		1	122	1861	40								
18	Oyster	11		TRA 16	1814	50	1	22	1852	Vac.	1	88	1856	Vac.	OLD LEXINGTON
19	Oyster	11		TRA 110	1832										
20	Oyster	11		TRA 124	1833										
21	Fish Creek	15		TRA 126	1833		TRA 190	1841							
22	Smith-Northwest	36		1	89	1856	40								
23	Bandy	17	137	3	97	1912									
24	Ellett	27		TRA 130	1833		1	122	1861						
25	Mahoning-Stark Co. Line	1		1	125	1861	45								
26	South Range	26		1	89	1856	40								
27	Beloit-Snodes	25		TRA 172	1837										
28	Beloit-Snodes	25		1	228	1872	35								
29	Mahoning-Portage Co. Line	2		* TRB 254	1834		1	86	1855	Vac.	4	474	1943	Vac.	* Estab. State Road by Legislature.
30	Martin	13		TRA 167	1836		7	319	1981	Vac.					PART VACATED 1981 VOL. 7 - PG. 319-322
31	Courtney	22		TRA 34	1822	40	TRA 227	1837							
32	Alliance-Salem	SH84		* TRA 24	1818	60	TRA 122	1833							* Estab. State Road by Legislature.
33	Beloit-Snodes	25		* TRB 250	1834		TRB 263	1835			4	381	1936	60	* Estab. State Road by Legislature.
34	Heisler	72		TRA 83	1829										
35	CALLA Rd.	30		TRA 60	1829										
36	Best	70	63	2	137	1885	49 1/2								CSR 325 1885
37	Oyster	11	82-153	2	189	1898	35	4A	25	1916	35				
38	Mahoning-Stark Co. Line	1	94-95	2	256	1901	50								Not Open
39	Holes Plat			3	457	1920									Vac. Streets & Alleys
40	Norman Ave.	255		3	541	1920									
41	Mahoning-Stark Co. Line	1	186	4	113	1922	50	4	271	1922	Vac.				
42	Lake Park	268	155	4	13	1930	50								
43	Fifteenth Street	270	179	4	307	1932	60								
44	Helsel	59		TRB 263	1835										
45	MAHONING-STARK C.L.		217	4	350	1937	Var.								Estab. S.H. Dec. 1937
46	First East			4	482	Vac.	1943								
47	PINE LAKE RD.	20	304	5	581	1956	60'								EWING-WOOLMAN RD.

SPRINGFIELD TOWNSHIP ROAD RECORD
INDEX TO ESTABLISHMENTS & VACATIONS

⑧ Number on Road indicates Index Number
50 Number over Road indicates Width of R.of W.

RANGE 1 - TOWNSHIP 9

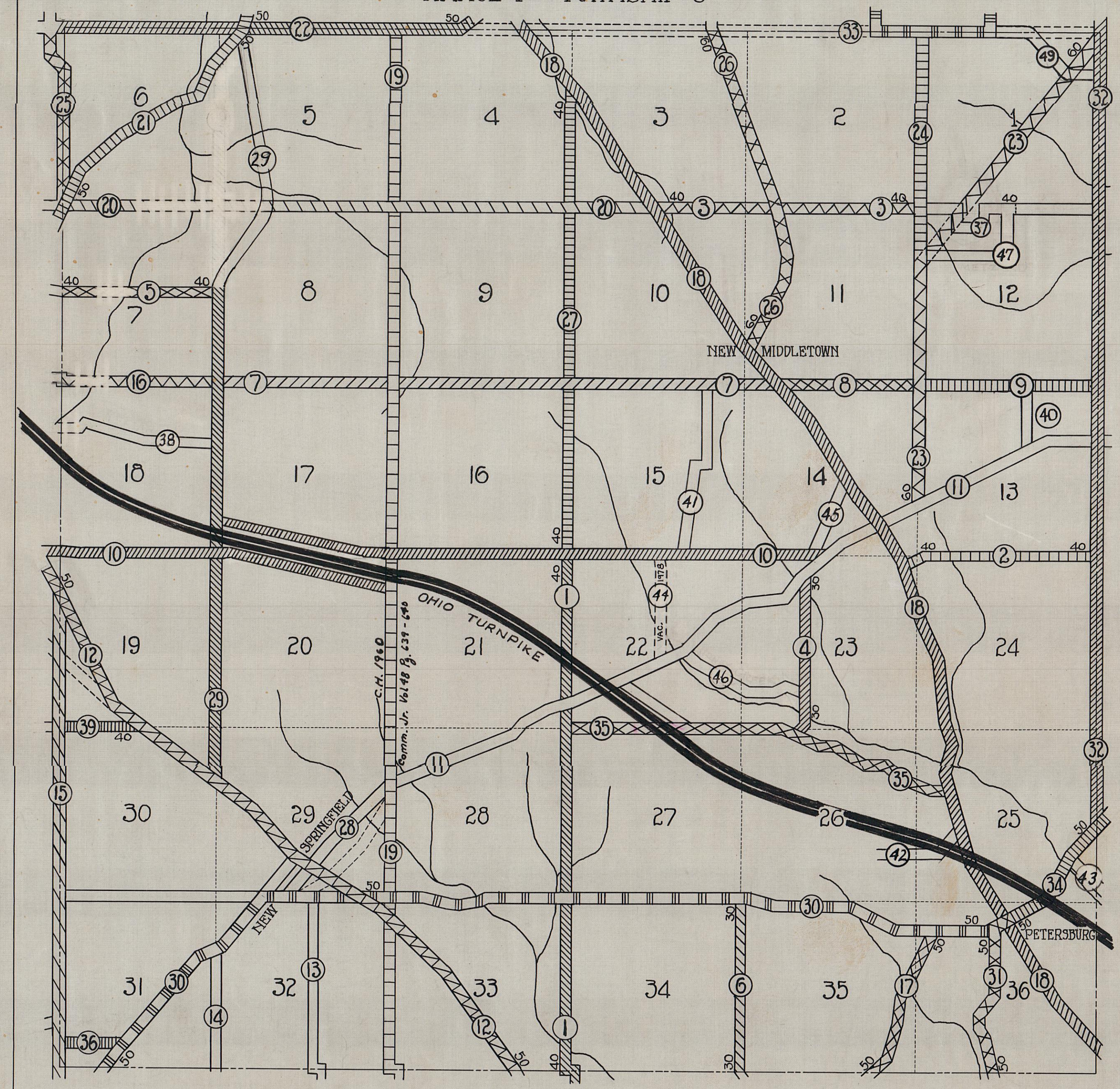

George M. Montgomery
County Surveyor.

SPRINGFIELD TOWNSHIP ROAD RECORD
INDEX TO ESTABLISHMENTS & VACATIONS

INDEX NO	NAME OF ROAD.	COUNTY ROAD NO.	SURVEYOR FILE NO	ESTABLISHED		ALTERED		ALTERED		REMARKS
				RD. BK. VOL. PG.	DATE WIDTH	RD. BK. VOL. PG.	DATE WIDTH	RD. BK. VOL. PG.	DATE WIDTH	
1	UNITY Rd.	175		1	9 1848 40					
2	South Range	26		1	12 1848 40					
3	New Middletown-Mt. Jackson	S.H.921	215	1	13 1848 40	4	359 1936 60	4	342A 1937 60	Estab. S.H. Apr. 1937
4	Harman	207		1	106 1860 30	5	73 1947 Vac			
5	Paulin	54		1	115 1861 40					
6	Hofmeister	189		1	142 1863 30					
7	MIDDLETOWN Rd.	28		TRA	118 1833	4	343 1937			
8	MIDDLETOWN Rd.	28		TRA	65 1829					
9	MIDDLETOWN Rd.	28		TRA	213 1845					
10	South Range	26		TRA	279 1825					
11	Columbiana-New Castle	62								No Record.
12	North Lima-East Palestine	S.H.89		TRA	2 1805 50					SR. 165 * Estab. State Road by Legislature
				*TRA	43 1828					Township Road.
13	Macklin	165								Township Road.
14	Kibler	159								
15	Beaver-Springfield	149		TRA	170 1836					
16	MIDDLETOWN Rd.	28	215	TRA	211 1845	4	343 1937 60			
17	WATERFORD Rd.	201		TRA	22 1817 50					
18	Youngstown-Pittsburg	S.H.83		TRA	42 1828					SR. 90/170
19	Beard	167	263	TRA	108 1832	5	255 1952 ALT.			
20	CALLA Rd.	50		TRA	81 1829	4	339	5	69 1947 Vac 60	
21	North Lima	163		TRA	4 1805 50	TRA	142 1834 60	4	426 1940	
22	Western Reserve	32		TRA	25 1819 50					* Estab. State Road by Legislature.
				*TRB	254 1834					
23	Rapp	211		TRA	27 1819 60					
23	Felger	233		TRA	27 1819 60					
24	Rapp	211		TRA	152 1836					
25	SOUTH AVE. EXT.	S.H.502		TRA	114 1832					
26	STRUTHERS Rd.	195		TRA	19 1816 50					
				TRB	85 1823 60					
27	UNITY Rd.	175		TRA	148 1835 40					
28	Columbiana-New Castle	62				TRA	205 1845			
29	SPRINGFIELD Rd.	161		TRA	67 1828	5	61 1947 Vac	5	65 1947	RELOC.
30	Garfield	862-SH.833		TRA	21 1817 50	4	387 1936 50			Estab. S.H. Nov. 1936
31	Unity-Petersburg	S.H.500		TRA	19 1816 50					
32	Ohio-Penn. State Line	5		1	3 1847					
33	Western Reserve	32		TRB	254 1834					See Poland Twp. Index No. 7
34	Garfield	8		TRA	22 1817 50					
				TRA	182 1838	TRA	216 1843			
35	PINE LAKE Rd.	20		TRA	72 1828	TRA	192 1842	5	249 1953 ALT.	
36	LIPPLY Rd.	60		TRA	184 1839					
37	CALLA Rd.	30	52			2	146 1888 40			Vac.
38	YERIAN Rd.	58				5	83 1947 Vac			
39	PINE LAKE Rd.	20	114	2	400 1908 40					
40	MOORE	215				4	332 1938 Vac	4	398 4 1938	
41	BRUNGARD	193		4	552 1948 50					
42	ORCHARD DR.	281		4	527 1943					
43	WALLACE Rd.	205								
44	MYERS Rd.	191								VAC. VOL. 7-PG. 221-227 1978
45	LOCUST DR.	209	Comm. J.E. 40	834						Haller Rd.
46	HONEY CREEK Rd.	64								
47	METZ Rd.	235								
48	GLACIER	297								
49	DONALDSON RD	324								

SR 630

SR 90/170

SR 170

